

falmec



Brera

INSTRUCTIONS BOOKLET

LIBRETTO ISTRUZIONI ^{IT}
INSTRUCTIONS BOOKLET ^{EN}
GEBRAUCHSANWEISUNG ^{DE}
MODE D'EMPLOI ^{FR}
MANUAL DE INSTRUCCIONES ^{ES}
ИНСТРУКЦИИ ^{RU}

INSTRUKCJA OBSŁUGI ^{PL}
BRUGSANIVSNINGER ^{DA}
HANDLEIDING ^{NL}
OHJEKIRJA ^{FI}
MANUAL DE INSTRUÇÕES ^{PT}

Motore in posizione anteriore (installazione a parete) - 90 cm

Motor in front position (wall installation) - 90 cm

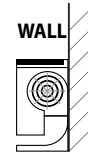
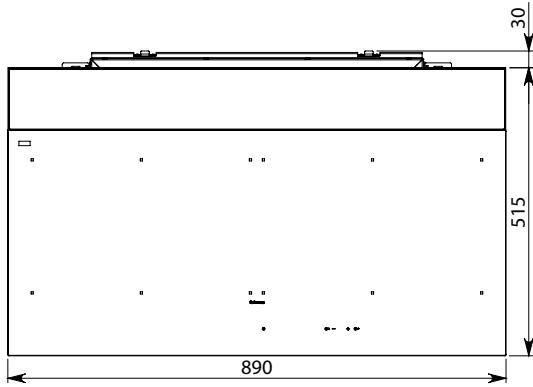
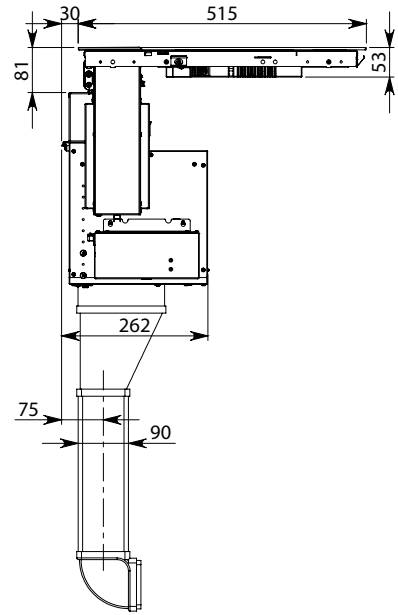
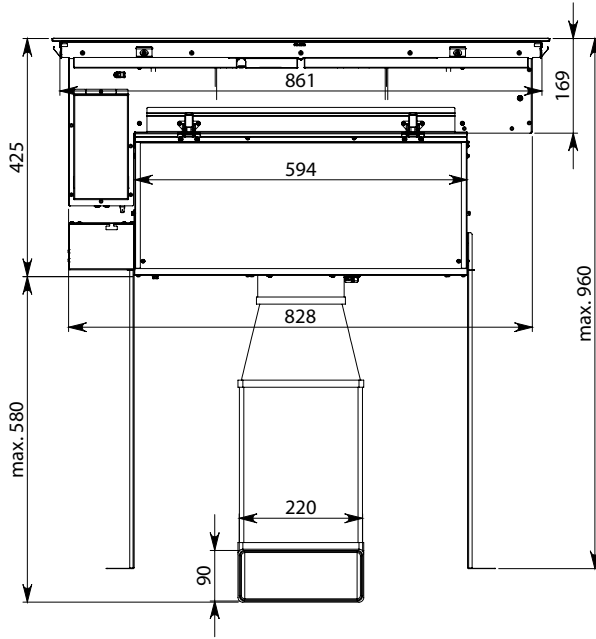

 30 kg

IT - Misure foro per incasso.

EN - Hole measurements for installation.

DE - Lochabmessungen für Einbau.

FR - Mesures du trou pour encastrement.

ES - Medidas del orificio para empotrado.

RU - Размеры монтажного отверстия.

PL - Wymiary otworu do zabudowy.

DA - Mål til åbning for indbygning.

NL - Maten gat voor inbouw.

FI - Aukon mittaukset asennusta varten.

PT - Medidas do furo para embutir.

INSTALLAZIONE IN APPOGGIO TOP-MOUNTED INSTALLATION

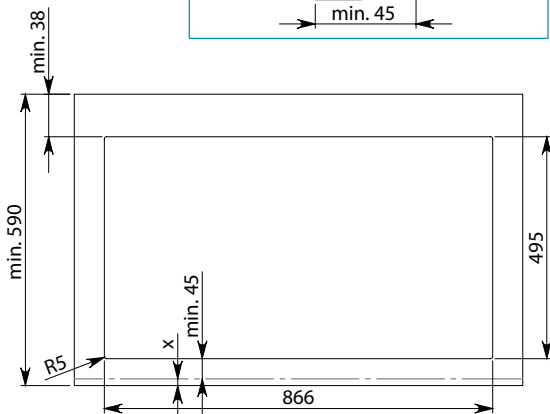
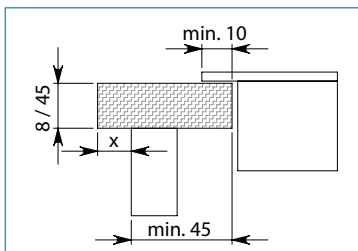

INSTALLAZIONE A FILO FLUSH-MOUNTED INSTALLATION

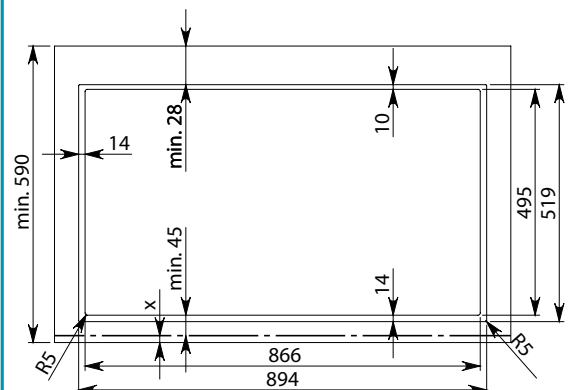
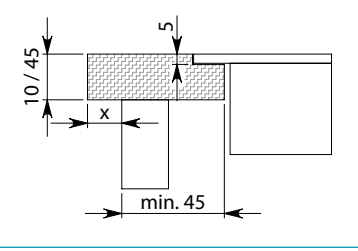

Motore in posizione anteriore (installazione a parete) - 75 cm

Motor in front position (wall installation) - 75 cm

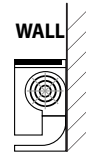
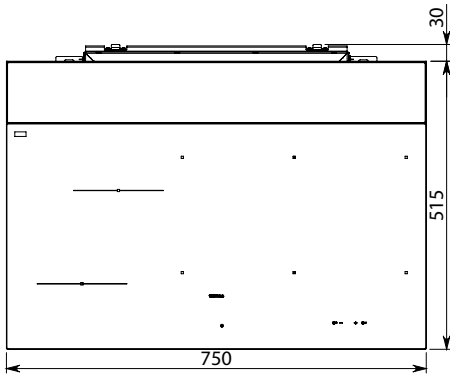
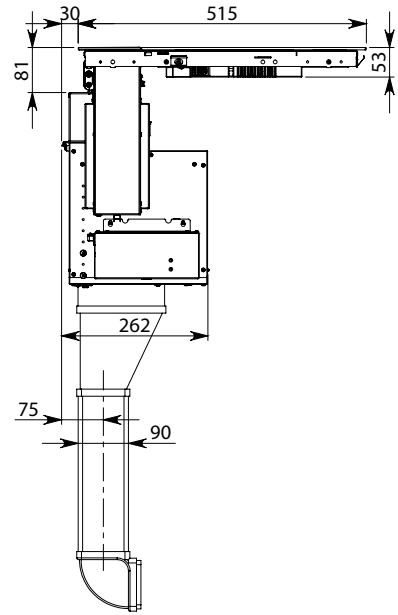
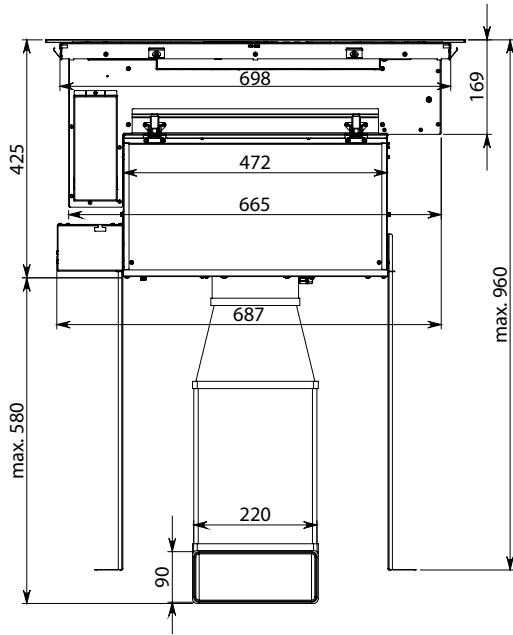

 28 kg

IT - Misure foro per incasso.

ES - Medidas del orificio para empotrado.

NL - Maten gat voor inbouw.

EN - Hole measurements for installation.

RU - Размеры монтажного отверстия.

FI - Aukon mittaukset asennusta varten.

DE - Lochabmessungen für Einbau.

PL - Wymiary otworu do zabudowy.

PT - Medidas do furo para embutir.

FR - Mesures du trou pour encastrement.

DA - Mål til åbning for indbygning.

INSTALLAZIONE IN APPOGGIO TOP-MOUNTED INSTALLATION

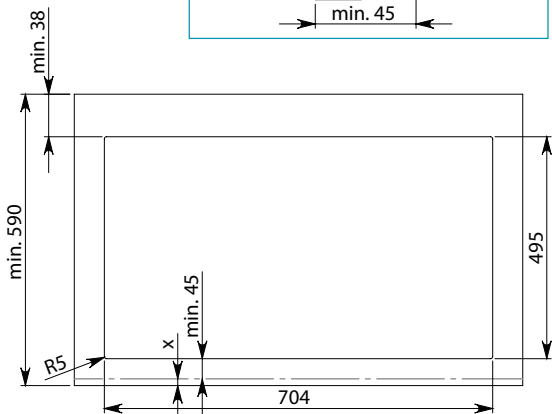
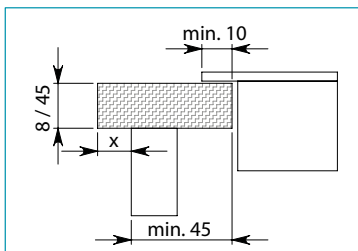

INSTALLAZIONE A FILO FLUSH-MOUNTED INSTALLATION

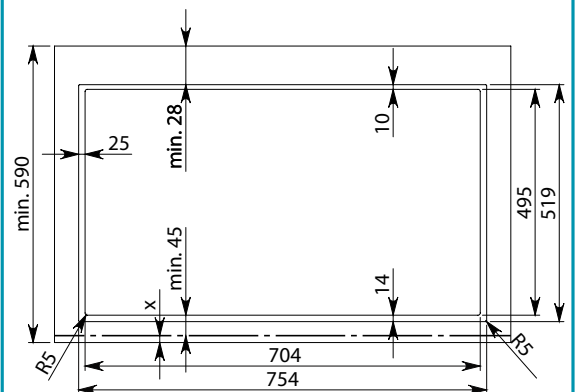
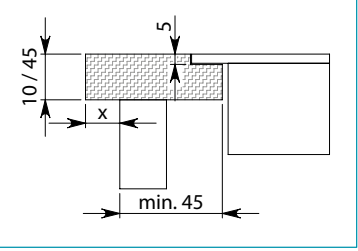

Motore in posizione posteriore (installazione ad isola)
Motor in rear position (island installation)

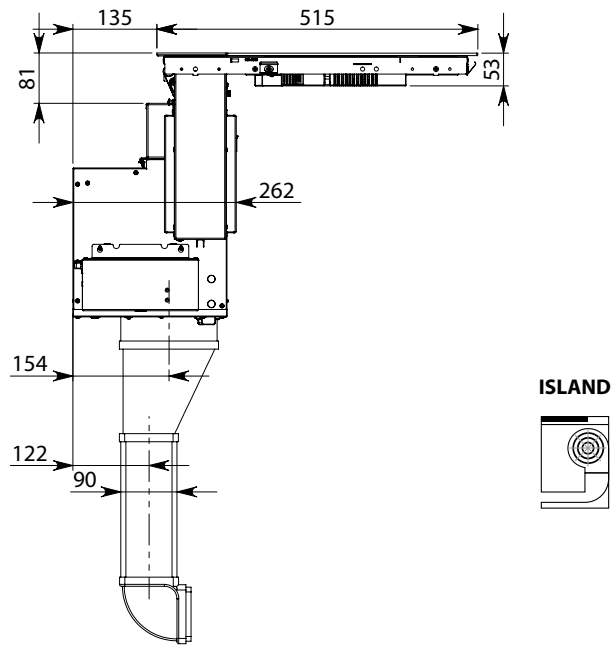

Installazione con Silence Kit KACL.1026 (opzionale)
Installation with Silence Kit KACL.1026 (optional)

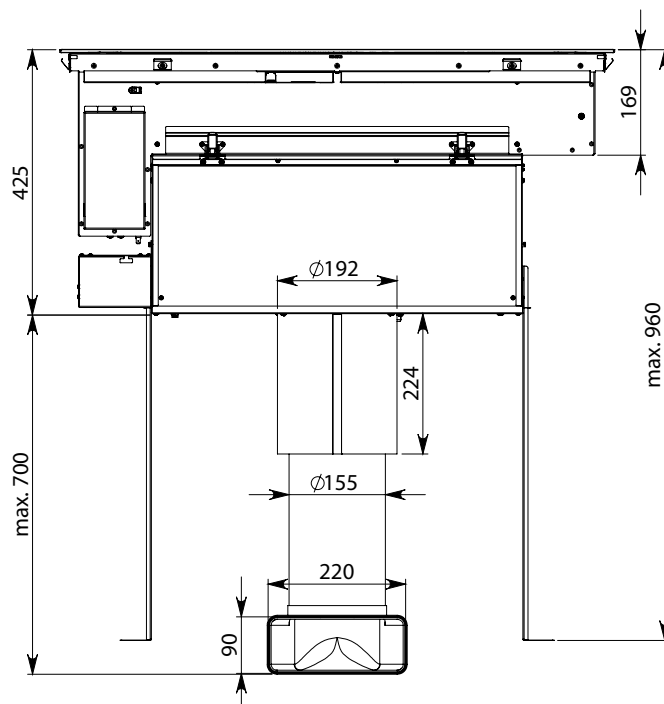

ESEMPI DI INSTALLAZIONE - INSTALLATION EXAMPLE

Motore in posizione anteriore (installazione a parete)
Motor in front position (wall installation)

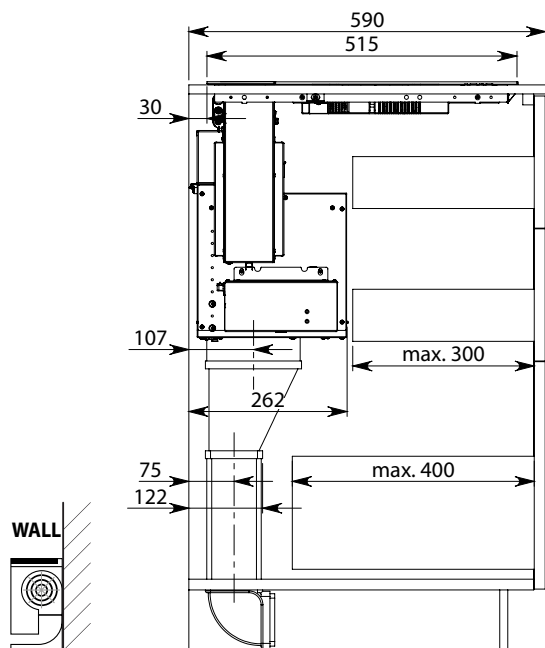

Motore in posizione posteriore (installazione ad isola)
Motor in rear position (island installation)

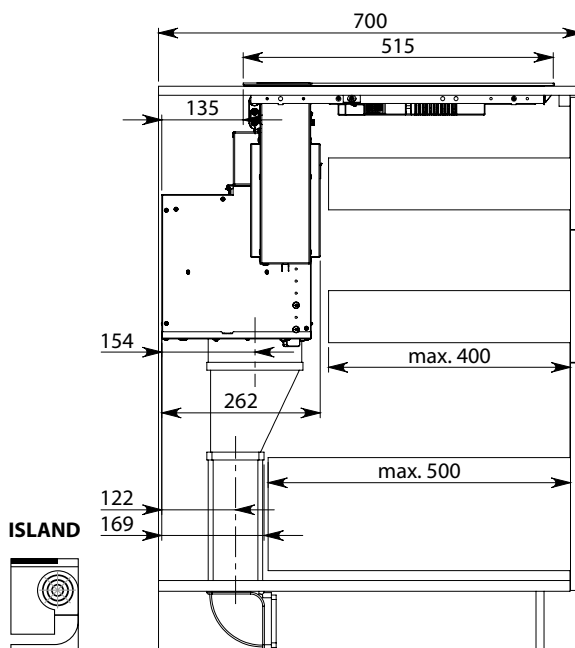

**Motore in posizione anteriore con
 Silence Kit KACL.1026 (opzionale)**
Motor in front position with Silence Kit KACL.1026 (optional)

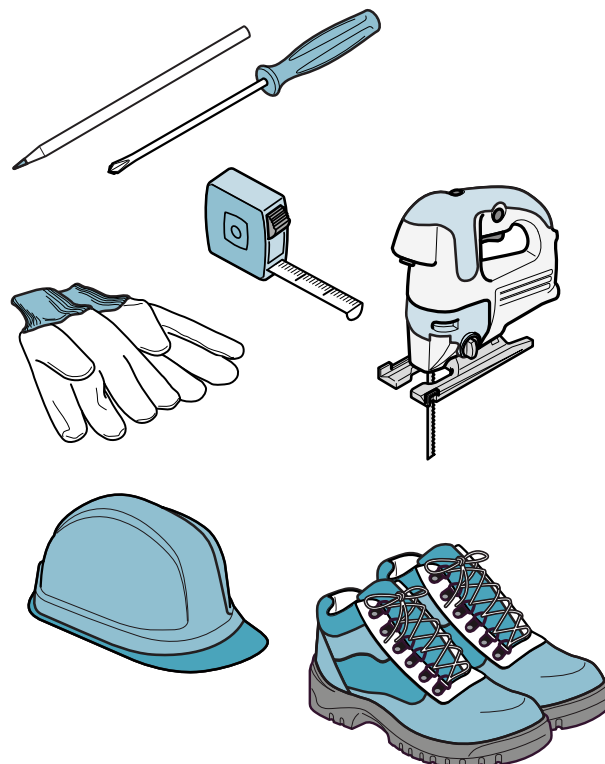
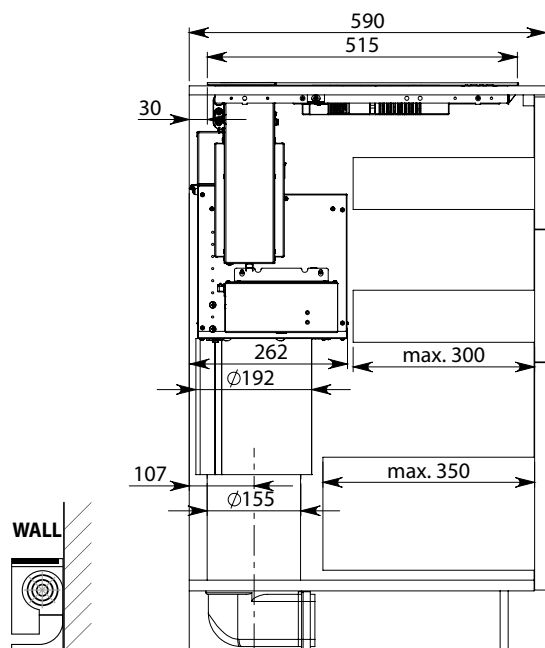

- IT** - Operazioni preliminari: Togliere il vetro e il cassetto (1). In base alla posizione del motore, può essere necessario riposizionare la scatola dell'elettronica (2).
- EN** - Preliminary operations: Remove the glass and the drawer (1). Depending on the position of the motor, it may be necessary to reposition the electronics box (2).
- DE** - Vorbereitungen: Das Glas und die Schublade (1) herausnehmen. Je nach Position des Motors kann es erforderlich sein, die Elektronikbox neu zu positionieren (2).
- FR** - Opérations préliminaires : Enlever le verre et le tiroir (1). En fonction de la position du moteur, il peut être nécessaire de replacer le boîtier électronique (2).
- ES** - Operaciones preliminares: Retire el cristal y el cajón (1). Dependiendo de la posición del motor, puede ser necesario reposicionar la caja de la electrónica (2).
- RU** - Предварительные операции: Снять стекло и ящик (1). В зависимости от положения двигателя может потребоваться изменить положение электронного блока (2).
- PL** - Czynności wstępne: Zdjąć szkło i wyjąć szufladę (1). W zależności od położenia silnika może być konieczna zmiana położenia skrzynki elektroniki (2).
- DA** - Indledende handlinger: Fjern glasset og kassen (1). Afhængigt af motorens placering kan det være nødvendigt at flytte elektronikboksen (2).
- NL** - Handelingen vooraf: Verwijder het glas en de lade (1). Afhankelijk van de positie van de motor kan het nodig zijn om de elektronicadoos te verplaatsen (2).
- FI** - Alustavat toimenpiteet: Poista lasi ja laatikko (1). Moottorin asennosta riippuen elektroniikkaosien kotelo on ehkä asetettava uudelleen (2).
- PT** - Operações preliminares: Retirar o vidro e a gaveta (1). Consoante a posição do motor, pode ser necessário reposicionar a caixa da eletrónica (2).

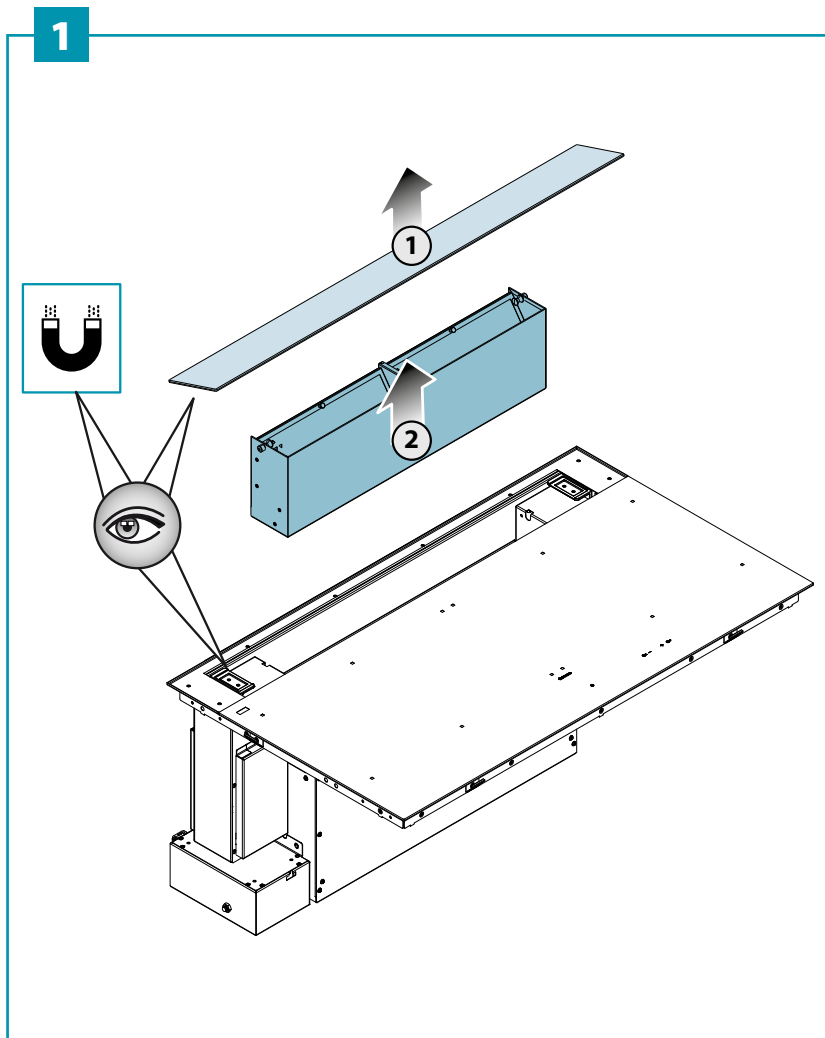

2

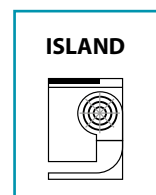
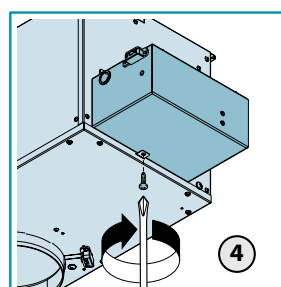
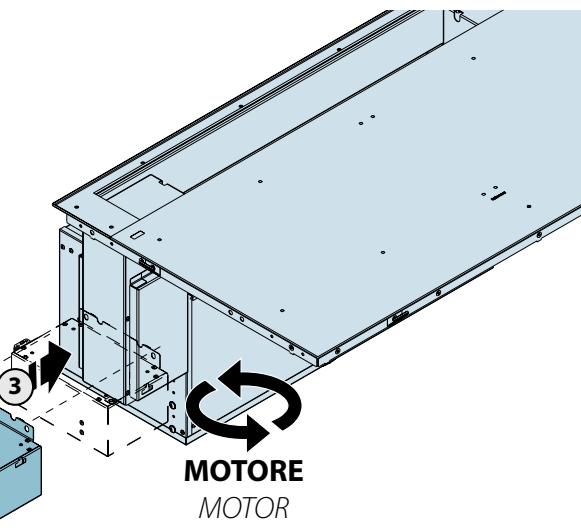
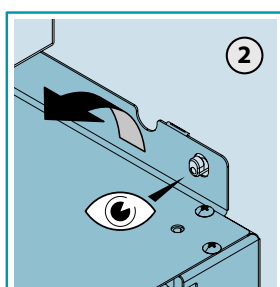
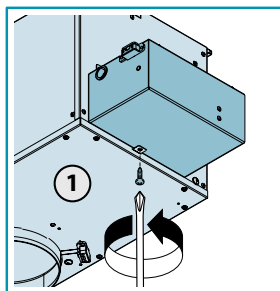
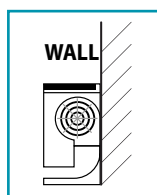
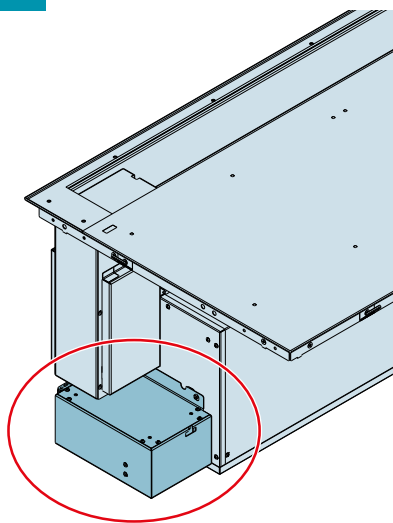

IT - Collegamento cavo di alimentazione del piano cottura (3). Distanze di sicurezza (4). Operazioni preliminari: Taglio del top (5).

EN - Connection of the power cable of the cooking hob (3). Safety distance (4). Preliminary operations: Cutting the top (5).

DE - Anschluss des Versorgungskabels der Kochfläche (3). Sicherheitsabstände (4). Vorbereitende Arbeiten: Schneiden Sie die Spitze (5).

FR - Branchement câble d'alimentation du plan de cuisson (3). Distances de sécurité (4). Opérations préliminaires: Couper le haut (5).

ES - Conexión del cable de alimentación de la placa de cocción (3). Distancias de seguridad (4). Operaciones preliminares: Cortando la parte superior (5).

RU - Подсоединение токоподводящего кабеля варочной поверхности (3). Безопасное расстояние (4). Предварительные операции: Вырезание верхней части (5).

PL - Podłączenie kabla zasilania płyty grzewczej (3). Odległości bezpieczeństwa (4). Operacje wstępne: Cięcie górnej części (5).

DA - Tilslutning af kogepladens forsyningskabel (3). Sikkerhedsafstand (4). Indledende handlinger: Skær toppen (5).

NL - Aansluiting voedingskabel van de kookplaat (3). Veiligheidsafstanden (4). Handelingen vooraf: Snijden van de top (5).

FI - Keittolieden virtajohdon liitännä (3). Turvaetäisyys (4). Alustavat toimenpiteet: Tason leikkaaminen (5).

PT - Ligação do cabo de alimentação do fogão (3). Distâncias de segurança (4). Operações preliminares: Corte da parte superior (5).

3

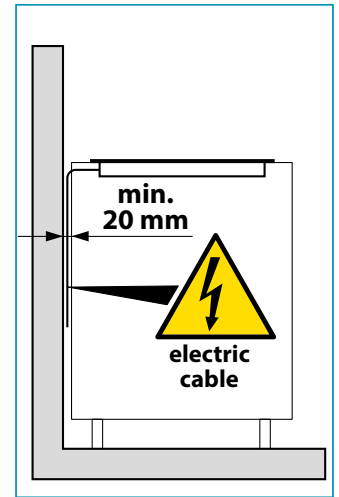
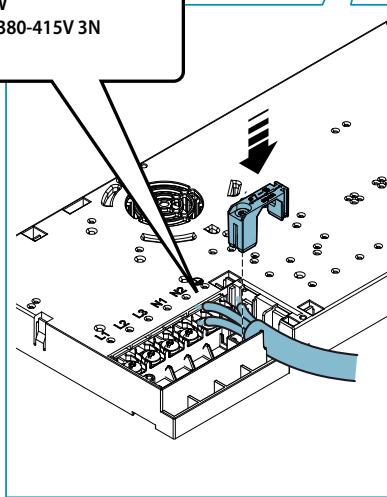
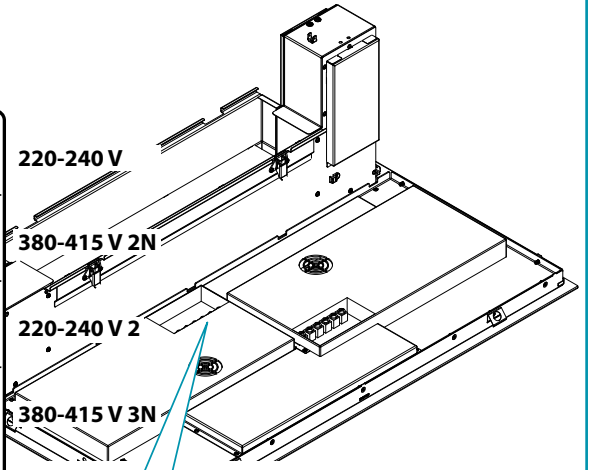
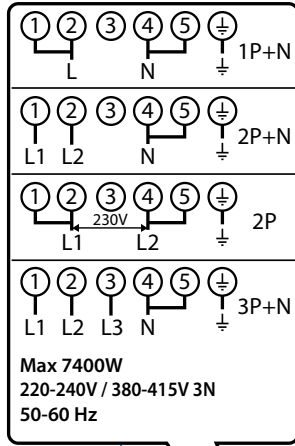

4

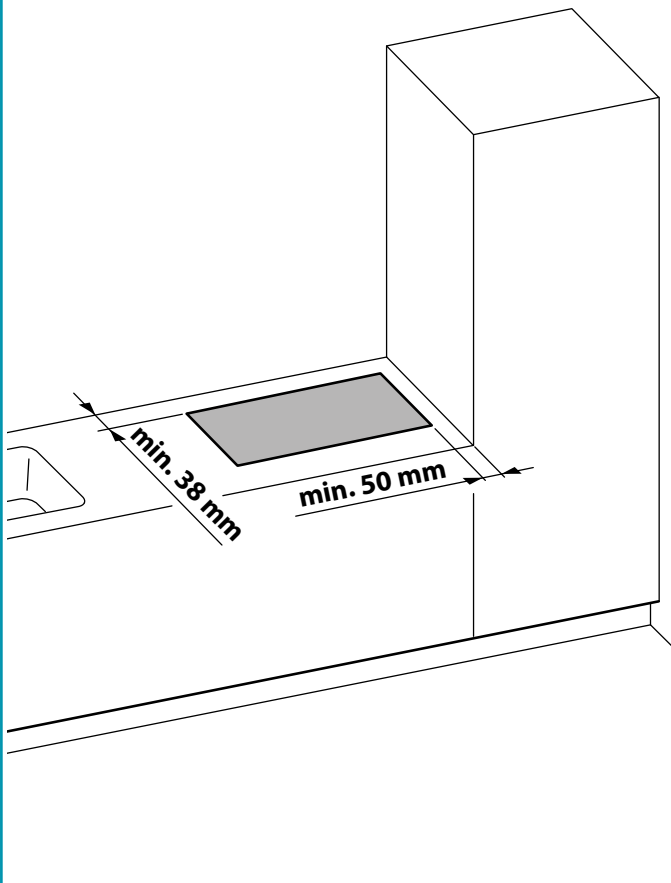

5

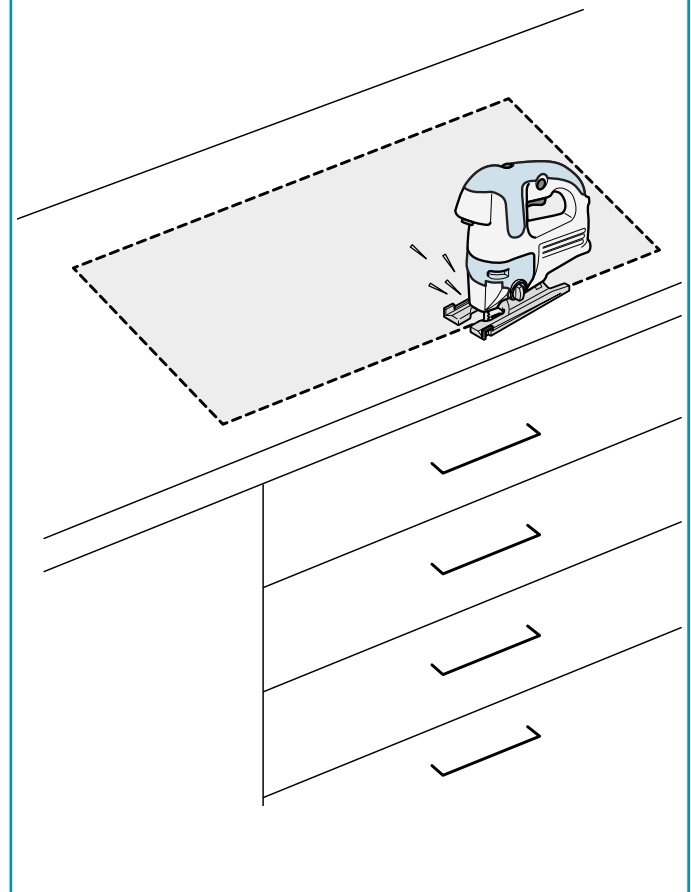

6

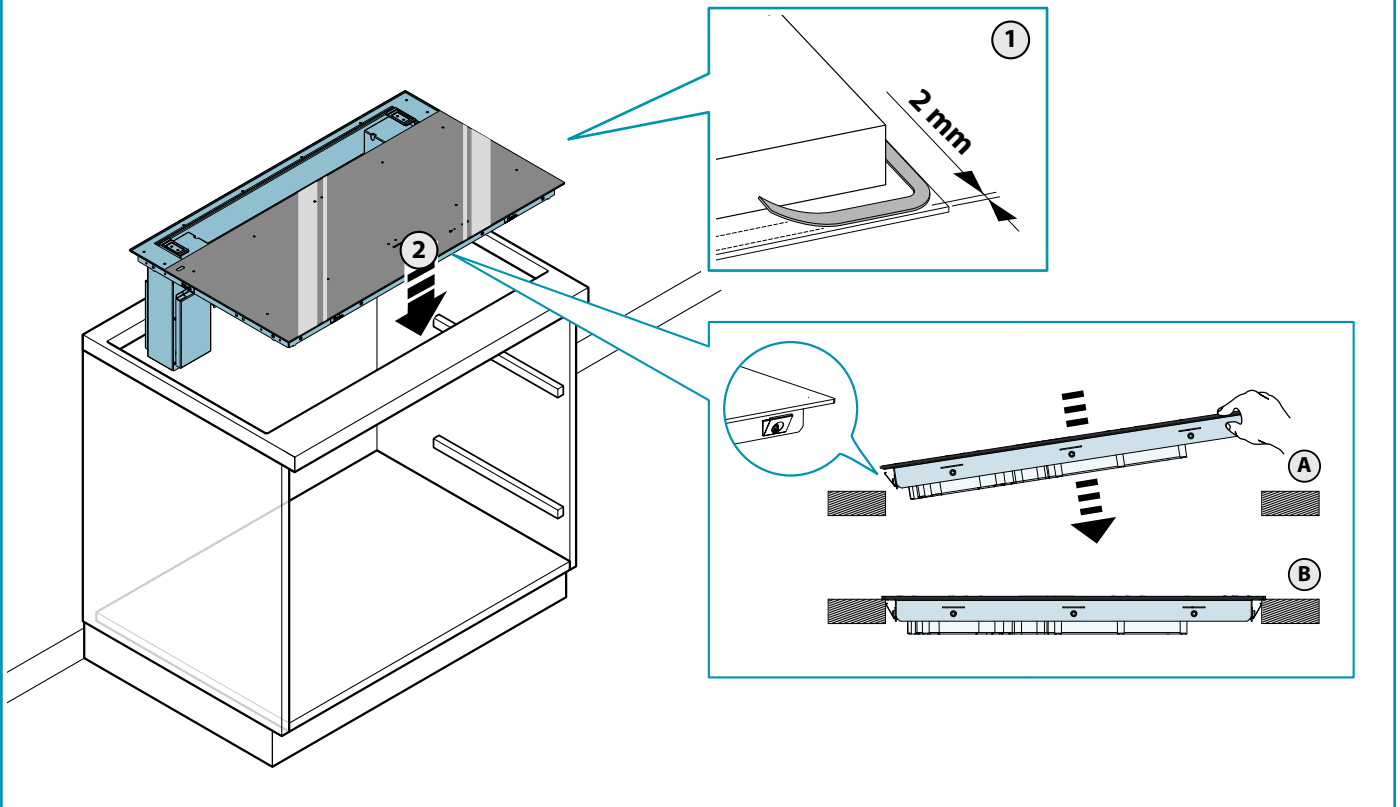

IT - Inserimento cappa su base (6).
Installazione tubo NRS (opzionale) (7).

EN - Insertion of the hood onto the base (6).
Fastening of NRS pipe (optional) (7).

DE - Einsetzen der Haube auf der Basis (6).
Befestigung des Rohrs NRS (Option) (7).

FR - Insertion de la hotte sur la base (6).
Fixation du tube NRS (en option) (7).

ES - Inserción de la campana en la base (6).
Fijación del tubo NRS (opcional) (7).

RU - Установка вытяжки на основание (6).
Крепление трубы NRS (дополнительного) (7).

PL - Umieszczenie okapu na podstawie (6).
Mocowanie rury NRS (opcjonalna) (7).

DA - Isætning af emhætten på underlaget (6).
Fastgørelse af NRS-rør (valgfrist) (7).

NL - Plaatsing afzuigkap op basis (6).
Bevestiging NRS (optie) (7).

FI - Liesituulettimen asentaminen alustaan (6).
NRS-putken kiinnitys (lisavaruste) (7).

PT - Inserção do exaustor na base (6).
Instalação do tubo NRS (opcional) (7).

7

Silence Kit KACL.1026 (opzionale / optional)

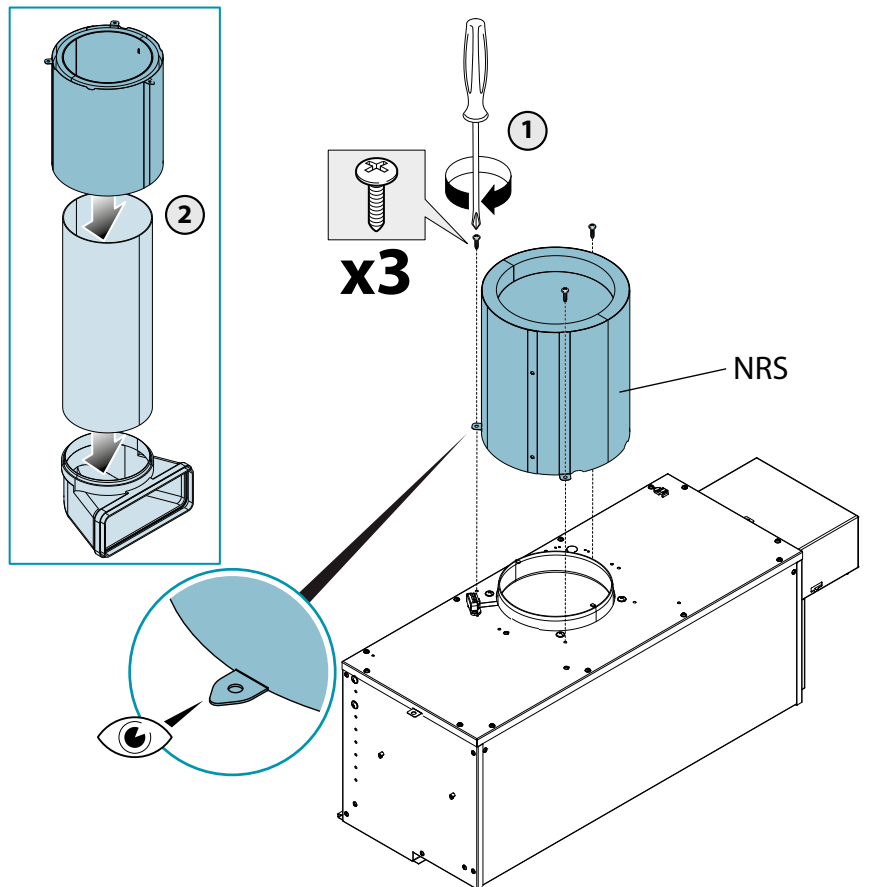

- IT - Avvitare le staffe di supporto (8).
 EN - Screw the support brackets in (8).
 DE - Die Halterungen (8) verschrauben.
 FR - Visser les brides de fixation (8).
 ES - Atornillar los soportes de apoyo (8).
 RU - Привинтите опорные кронштейны (8).
 PL - Dokręcić wsporniki (8).
 DA - Skru støttebøjlerne på (8).
 NL - Schroef de steunbeugels (8) vast.
 FI - Ruuvaa tuet kiinnikkeisiin kohdassa (8).
 PT - Aparafusar os suportes de apoio (8).

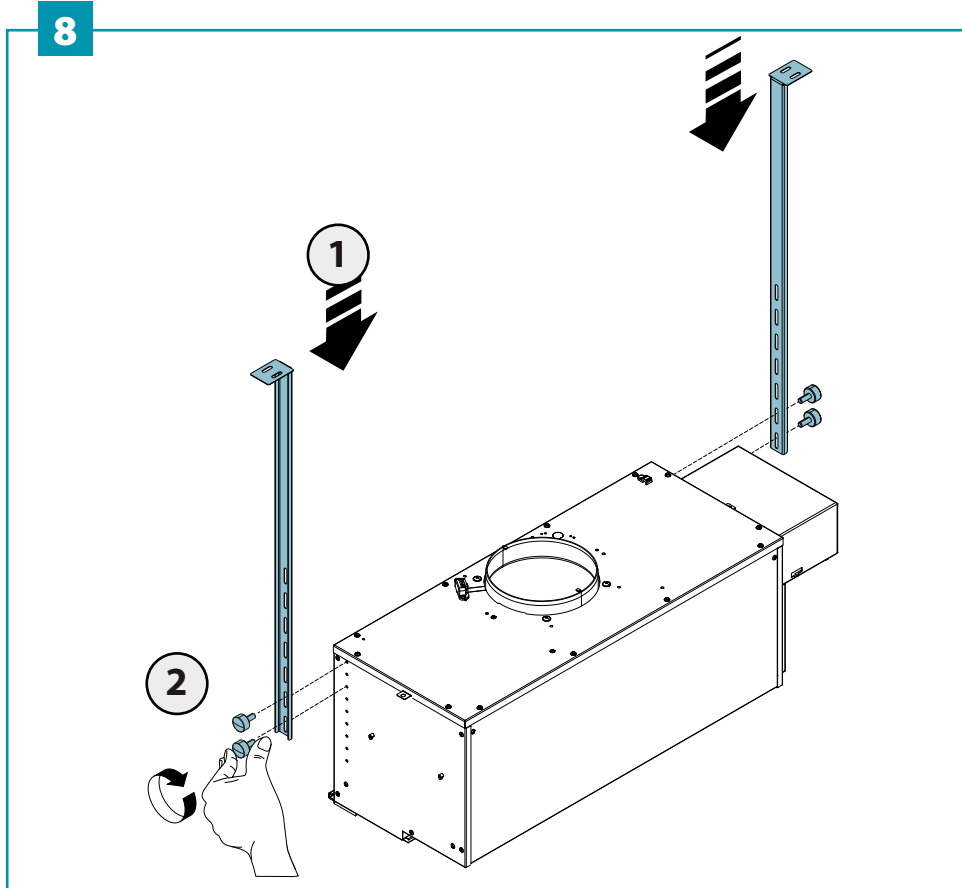

- IT - Posizionare il motore come indicato in figura e bloccarlo tramite le chiusure di fissaggio. (9).
 EN - Position the motor as shown in the figure and secure it by means of the fasteners. (9).
 DE - Positionieren Sie den Motor wie in der Abbildung gezeigt und befestigen Sie ihn mit den Befestigungselementen (9).
 FR - Placer le moteur comme indiqué sur la figure et le fixer à l'aide des attaches. (9).
 ES - Coloque el motor como se muestra en la figura y fíjelo mediante con los cierres. (9).
 RU - Расположите двигатель, как показано на рисунке, и закрепите его с помощью крепежных элементов. (9).
 PL - Ustawić silnik w sposób pokazany na rysunku i zablokować go za pomocą elementów mocujących. (9).
 DA - Placer motoren som vist på figuren, og fastgør den ved hjælp af fastgørelseselementerne. (9).
 NL - Plaats de motor zoals aangegeven in de afbeelding en zet hem vast met de bevestigingsmiddelen (9).
 FI - Aseta moottori kuvan osoittamalla tavalla ja kiinnitä se kiinnikkeillä. (9).
 PT - Posicione o motor como indicado na figura e fixe-o com os fechos de fixação. (9).

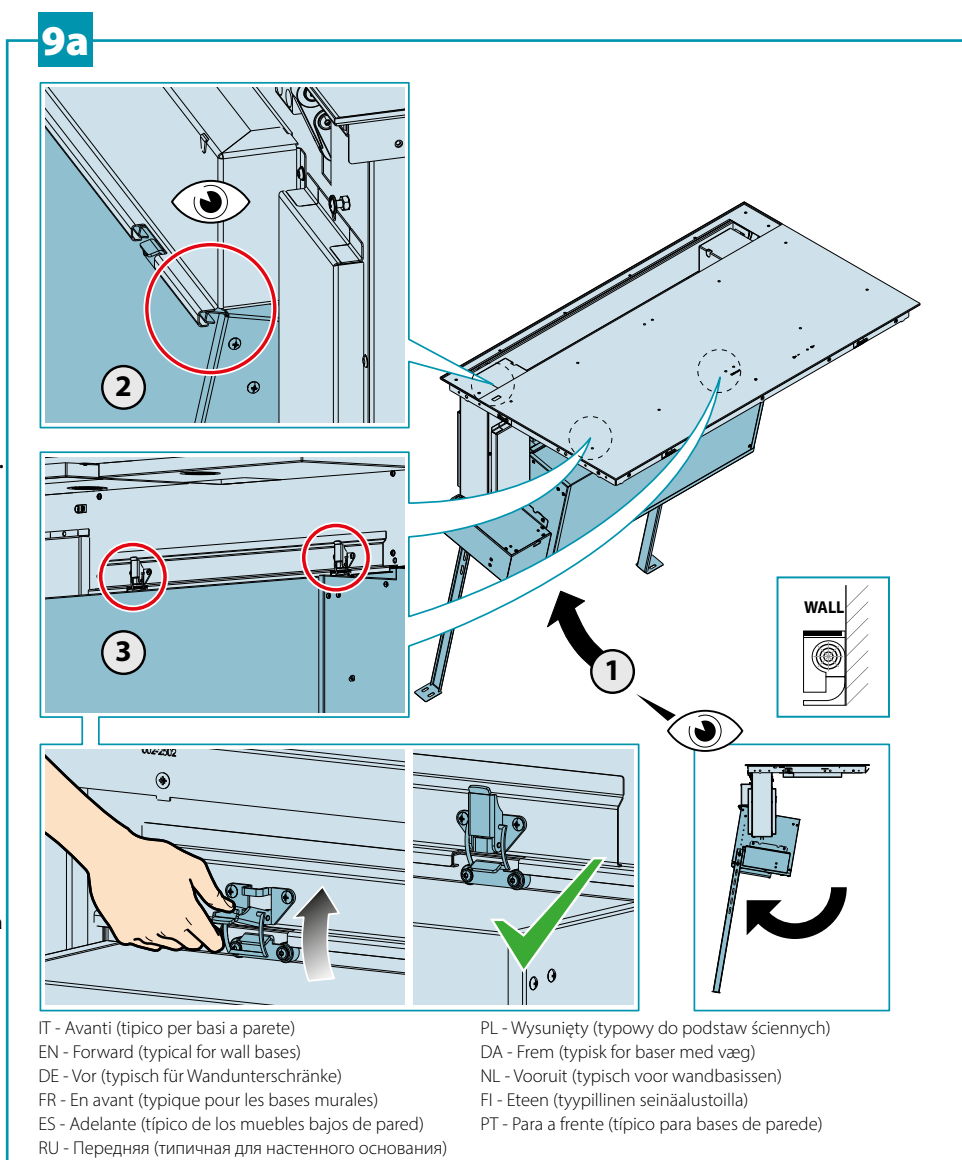

- IT - Avanti (tipico per basi a parete)
 EN - Forward (typical for wall bases)
 DE - Vor (typisch für Wandunterschranke)
 FR - En avant (typique pour les bases murales)
 ES - Adelante (típico de los muebles bajos de pared)
 RU - Передняя (типичная для настенного основания)

- PL - Wysunięty (typowy do podstaw ściennych)
 DA - Frem (typisk for baser med væg)
 NL - Vooruit (typisch voor wandbasissen)
 FI - Eteen (tyypillinen seinäalustoilla)
 PT - Para a frente (típico para bases de parede)

- IT - Posizionare il motore come indicato in figura e bloccarlo tramite le chiusure di fissaggio. (9).
- EN - Position the motor as shown in the figure and secure it by means of the fasteners. (9).
- DE - Positionieren Sie den Motor wie in der Abbildung gezeigt und befestigen Sie ihn mit den Befestigungselementen (9).
- FR - Placer le moteur comme indiqué sur la figure et le fixer à l'aide des attaches. (9).
- ES - Coloque el motor como se muestra en la figura y fíjelo mediante con los cierres. (9).
- RU - Расположите двигатель, как показано на рисунке, и закрепите его с помощью крепежных элементов. (9).
- PL - Ustawić silnik w sposób pokazany na rysunku i zablokować go za pomocą elementów mocujących. (9).
- DA - Placer motoren som vist på figuren, og fastgør den ved hjælp af fastgørelseselementerne. (9).
- NL - Plaats de motor zoals aangegeven in de afbeelding en zet hem vast met de bevestigingsmiddelen (9).
- FI - Aseta moottori kuvan osoittamalla tavalla ja kiinnitä se kiinnikkeillä. (9).
- PT - Posicione o motor como indicado na figura e fixe-o com os fechos de fixação. (9).

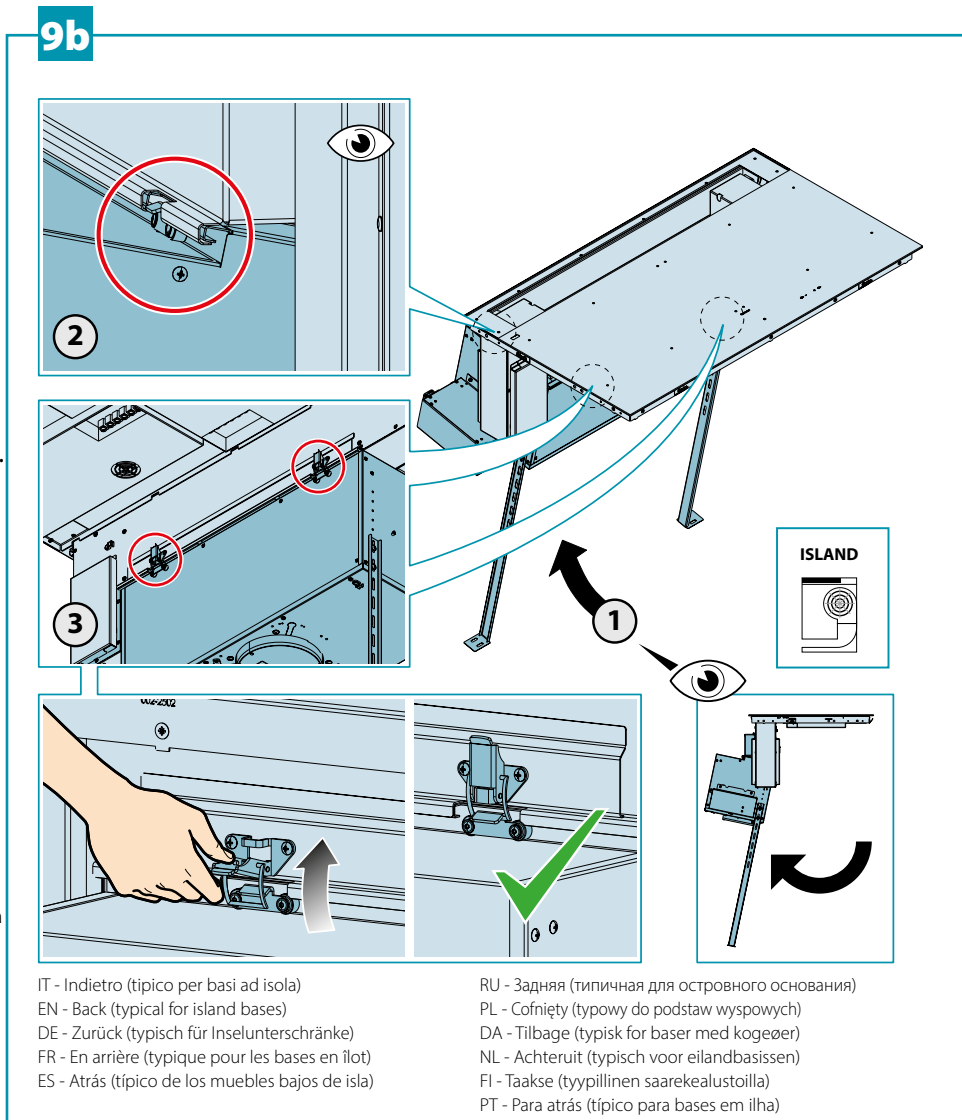

- IT - In particolari situazioni di installazione può risultare agevole fissare il motore alla cappa prima del suo inserimento nel top.
- EN - In special installation situations, it may be easy to attach the motor to the hood before it is inserted into the top.
- DE - In besonderen Einbausituationen kann es empfehlenswert sein, den Motor an der Abzugshaube zu befestigen, bevor er in das Oberteil eingesetzt wird.
- FR - Dans des situations d'installation particulières, il peut être facile de fixer le moteur à la hotte avant qu'elle ne soit insérée dans le top.
- ES - En situaciones especiales de instalación, puede resultar más sencillo fijar el motor a la campana antes de introducirla en la encimera.
- RU - В особых случаях можно просто прикрепить двигатель к вытяжке до того, как он будет вставлен в верхнюю часть.
- PL - W szczególnych sytuacjach montażowych może okazać się wskazane przymocowanie silnika do okapu przed wsunięciem go do górnej części.
- NL - In speciale installatiesituaties kan het gemakkelijk zijn om de motor aan de kap te bevestigen voordat hij in de top wordt geplaatst.
- DA - I særlige installationssituationer kan det være nemt at fastgøre motoren til emhætten, før den sættes ind i toppen.
- FI - Erityisissä asennustilanteissa voi olla helpompaa kiinnittää moottori liesituuletimeen ennen sen asentamista tasoon.
- PT - Em situações de instalação especiais, pode ser mais fácil fixar o motor ao exaustor antes da sua inserção na parte superior.

10

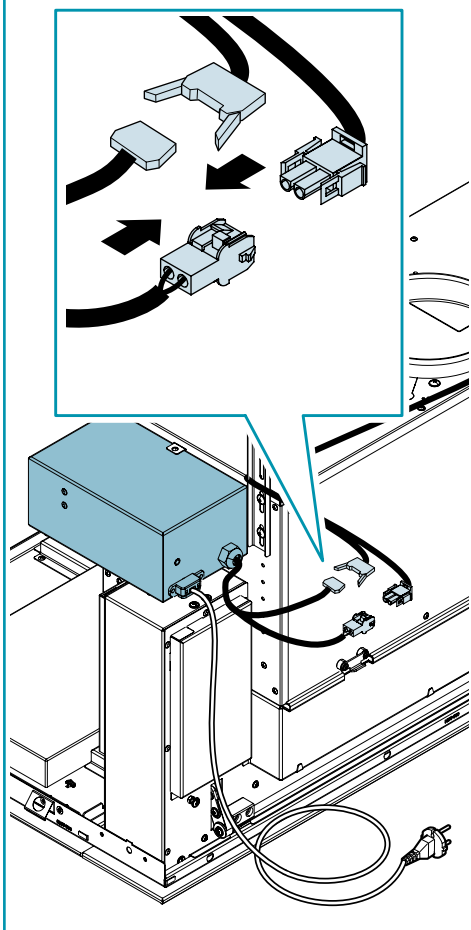

IT - Collegamenti cavo di comando (10). Regolare le staffe di supporto (11). Collegamenti elettrici motore e piano induzione (12).

EN - Connections of the control cable (10). Adjust the support brackets (11). Motor and induction hob electrical connections (12).

DE - Anschlüsse des Steuerkabels (10). Die Halterungen (11) einstellen. Elektrische Anschlüsse des Motors und der Induktionsfläche (12).

FR - Branchements câble de commande (10). Régler les brides de support (11). Branchements électriques moteur et plan à induction (12).

11

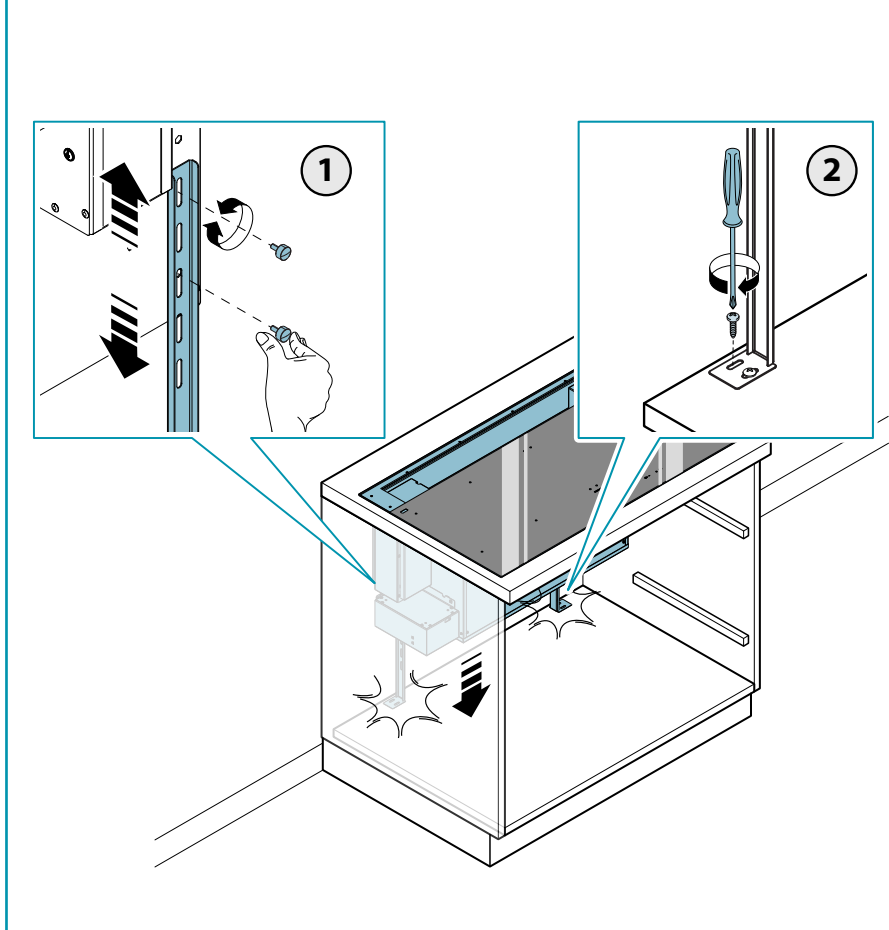

ES - Conexiones del cable de control (10). Regular los soportes de apoyo (11). Conexiones eléctricas del motor y placa de inducción (12).

RU - Подсоединения кабеля управления (10). Отрегулируйте опорные кронштейны (11). Электрические подключения двигателя и индукционной поверхности (12).

PL - Podłączenie kabla układu sterowania (10). Wyregulować wsporniki (11). Połączenia elektryczne silnika i płyty indukcyjnej (12).

DA - Tilslutninger til styrekablet (10). Justér støttebøjlerne (11). Motorens og induktionspladens elektriske tilslutninger (12).

NL - Aansluitingen besturingskabel (10). Stel de steunbeugels af (11). Elektrische aansluitingen motor en inductieplaat (12).

FI - Ohjauskaapelin liitännät (10). Säädä tukikiinnikkeitä (11). Moottorin ja induktiolieden sähköliitännät (12).

PT - Ligações do cabo de comando (10). Ajustar os suportes de apoio (11). Ligações elétricas do motor e da placa de indução (12).

12

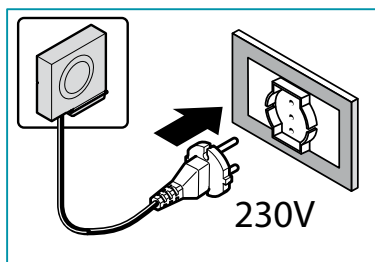
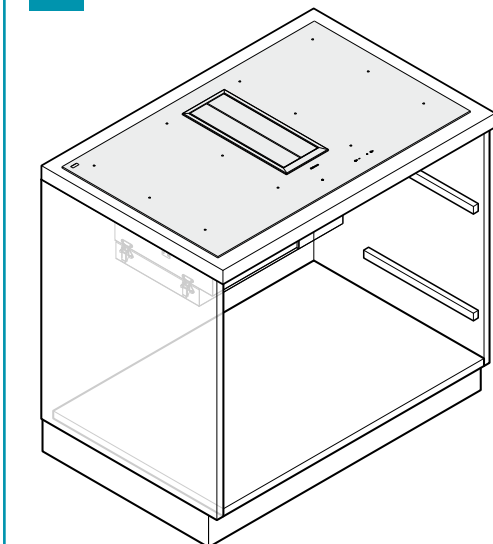

- IT - Installazione con cappa ad evacuazione esterna (aspirante) (13).
- EN - Installation with external exhaust hood (suction) (13).
- DE - Installation mit Abzugshaube in Version Außenbluft (Abluftversion) (13).
- FR - Installation avec hotte à évacuation extérieure (aspirante) (13).
- ES - Instalación con campana de evacuación externa (extractora) (13).
- RU - Установка с кухонной вытяжкой с выводом наружу (всасывающая) (13).
- PL - Instalacja z okapem z usuwaniem na zewnątrz (wyciągowy) (13).
- DA - Installation med emhætte med ekstern udledning (udsugende) (13).
- NL - Installatie met kap met (zuig) afvoer naar buiten (13).
- FI - Liesituulettimen asennus ulkoisella poistoputkella (imu) (13).
- PT - Instalação com exaustor de evacuação externa (aspirante) (13).

13

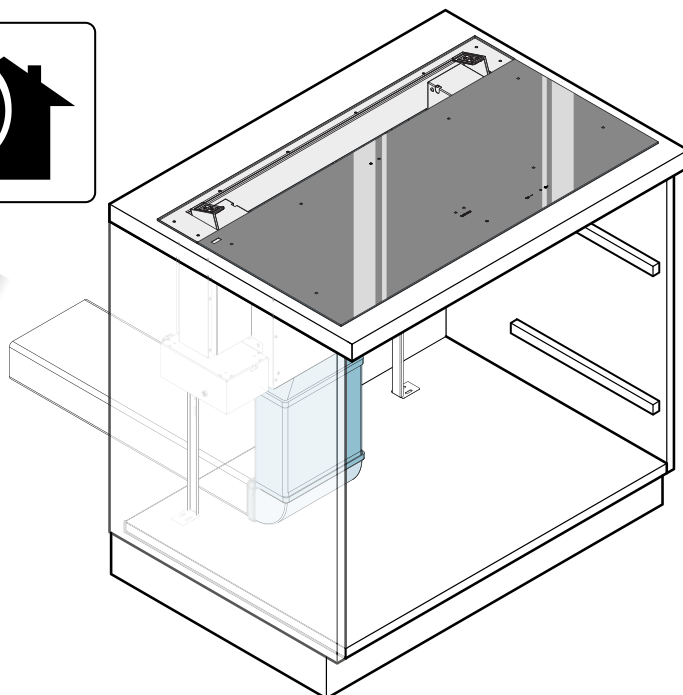
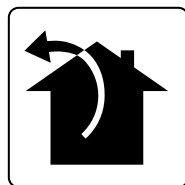

- IT - Installazione filtro carbone-zeolite (opzionale) (14).
- EN - Installing the carbon-zeolite filter (optional) (14).
- DE - Installation des Kohlenstoff-Zeolith-Filter (Option) (14).
- FR - Installation du filtre charbon-zéolite (en option) (14).
- ES - Instalación de filtro de carbón-zeolita (opcional) (14).
- RU - Установка угольного цеолитного фильтра (дополнительного) (14).
- PL - Instalacja filtra węglowo-zeolitowego (opcjonalna) (14).
- DA - Installation af zeolit-kulfilteret (valgfrit) (14).
- NL - Installatie koolstof-zeolietfilter (optie) (14).
- FI - Hiili-zeoliittisuodattimen asennus (lisävaruste) (14).
- PT - Instalação do filtro carbon-zeólita (opcional) (14).

14

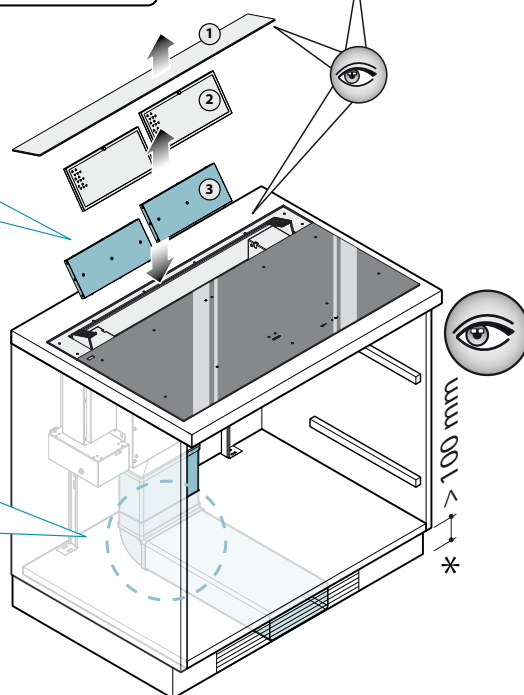
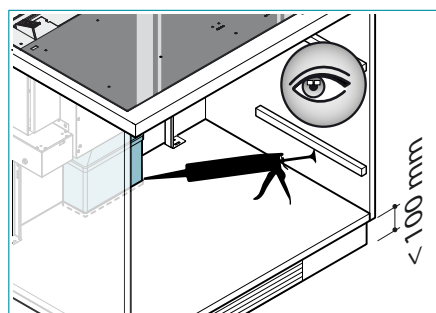
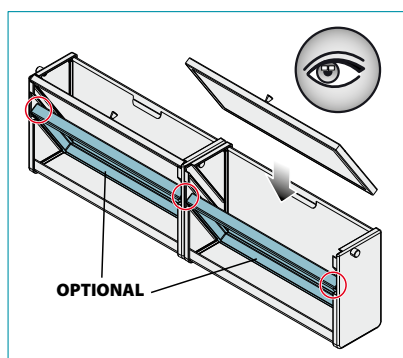

IT - *È fortemente consigliato installare almeno la curva evidenziata anche nella versione filtrante

EN - *It is strongly recommended to install at least the highlighted curve also in the filter version

DE - *Es wird dringend empfohlen, auch in der Filterversion zumindest die hervorgehobene Krümmung zu installieren

FR - *Il est fortement recommandé d'installer au moins la courbe mise en évidence dans la version filtrante

ES - *Se recomienda encarecidamente instalar al menos la curva mostrada, también en la versión filtrante

RU - *Настоятельно рекомендуется установить хотя бы выделенный изгиб также в фильтрующей версии

PL - *Zdecydowanie zaleca się zainstalowanie co najmniej kolanka rurowego zaznaczonego również w wersji filtrującej

DA - *Det anbefales på det kraftigste i hvert fald også at installere den fremhævede kurve i den filtrerede version

NL - *Het wordt ten zeerste aangeraden ten minste de aangegeven bocht ook in de filterversie te installeren

FI - *On erittäin suositeltavaa asentaa ainakin mutka, joka on korostettu myös suodatinversiona

PT - *É altamente recomendável instalar pelo menos a curva evidenciada também na versão com filtro

- IT - Riposizionamento cassetto filtri e veletta (15).
- EN - Repositioning of filter drawer and flap (15).
- DE - Neupositionierung der Filterschublade und der Blende (15).
- FR - Repositionnement du tiroir des filtres et la retombée (15).
- ES - Reposicionamiento del cajón de filtros y pestaña (15).
- RU - Размещение ящика фильтров и сетки (15).
- PL - Wkładanie szuflady filtrów uchylnego frontu (15).
- DA - Sæt filterkassen og skærmkanten tilbage igen (15).
- NL - Herpositionering lade filters en plaatje (15).
- FI - Suodatinlaatikon ja kannen uudelleenasettaminen (15).
- PT - Reposicionamento da caixa de filtros e base (15).

15

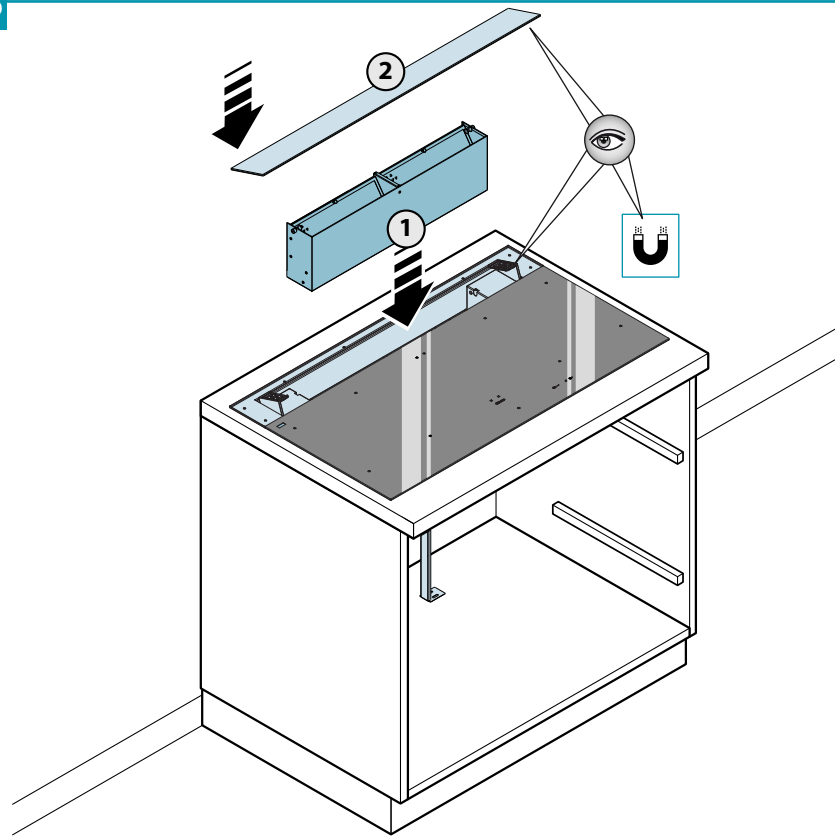

PULIZIA E MANUTENZIONE
 MAINTENANCE
 REINIGUNG UND WARTUNG
 NETTOYAGE ET ENTRETIEN
 LIMPIEZA Y MANTENIMIENTO
 ОЧИСТКА И УХОД

CZYSZCZENIE I KONSERWACJA
 RENGØRING OG VEDLIGEHOLDELSE
 REINIGING EN ONDERHOUD
 HUOLTO
 LIMPEZA E MANUTENÇÃO

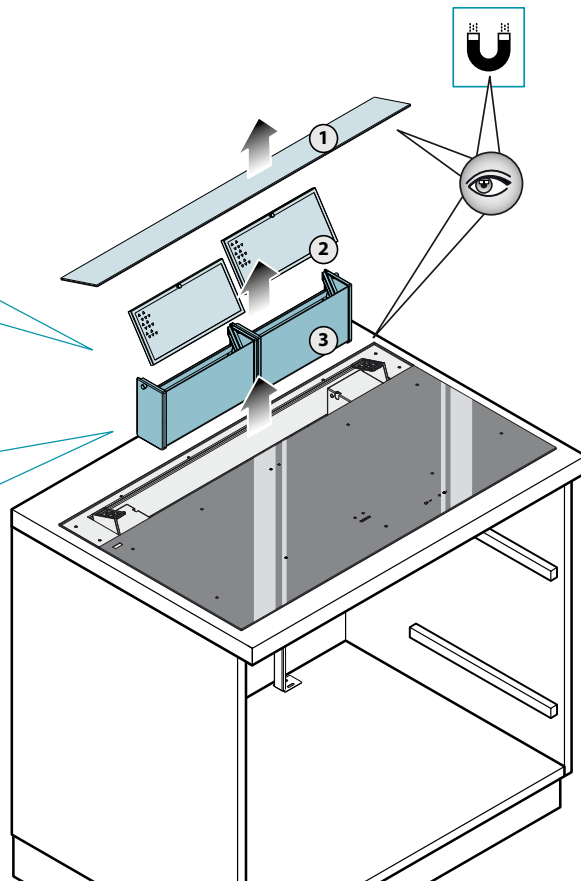
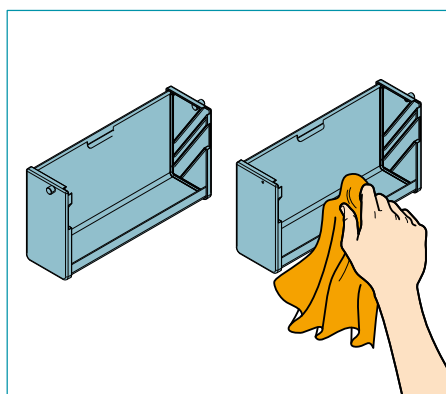
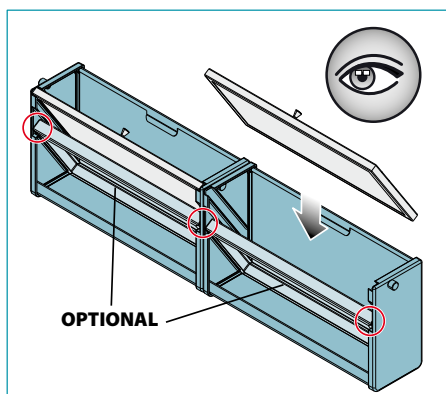

SAFETY INSTRUCTIONS AND WARNINGS



These warnings have been drawn up for your personal safety and those of others. You are therefore kindly asked to read the booklet carefully in its entirety before using or cleaning the equipment.

The Manufacturer declines all responsibility for any damage caused directly, or indirectly, to persons, things and pets as a consequence of failing to comply with the safety warnings indicated in this booklet.

It is imperative that this instructions booklet is kept together with the equipment for any future consultation.

If the equipment is sold or transferred to another person, make sure that the booklet is also supplied so that the new user can be made aware of the hood's operation and relative warnings.

Insist on original spare parts.

If the power cable is damaged, it must be replaced by the manufacturer or its technical service department or a similarly qualified person, so as to prevent any risk



Intended use

- This cooker is intended to be used in domestic environments to prepare and keep dishes warm.
- Do not install the cooker outdoors and do not expose it to outdoor environment (rain, wind, etc.).
- It is forbidden to use the cooktop on moving equipment.
- Any other use is not admitted.
- Do not use the cooker before installing it.
- Never open the case of the appliance.
- Falmec assures the compliance with the safety standards with original spare parts only.
- The appliance is not intended for use with external timer or remote control.
- The equipment can be used by children over the age of 8 and by persons with reduced physical, sensory and mental abilities, or with no experience or knowledge, as long as they do so under supervision or after having received relative instructions regarding safe use of the equipment and understanding of the dangers connected to it.
- Children are not to play with the equipment. Cleaning and maintenance by the user must not be carried out by children without supervision.
- Do not leave the cook top unmanned while it is working.

The equipment is solely intended to be used to

extract fumes generated from cooking food in non-professional domestic kitchens: any other use is improper. Improper use can cause damage to persons, things, pets and exempts the Manufacturer from any liability.



Danger of burns

- Use the control lock to avoid that unauthorised people can switch on the appliance by themselves.
- place handles of frying pans and saucepans in a way that children cannot touch them.
- Switch off the cooking areas after use.
- After use, switch off the hob elements via their control without relying on the pan detector
- Do not place any metal object on cooking areas that are on.
- Metal objects such as knives, forks, spoons or lids should not be placed on the hob surface because they can get hot



Technical safety

- Installation operations are to be carried out by skilled and qualified installers in accordance with the instructions in this booklet and in compliance with the regulations in force.
If the power cable or other components are damaged, the cook top shall NOT be used: disconnect the cooker from the power supply and contact the Dealer or an authorised Servicing Department for repairs.
- Do not modify the electrical, mechanical or functional structure of the equipment.
- WARNING: failure to install screws or fasteners in accordance with these instructions may lead to electrical hazards
- Do not personally try to carry out repairs or replacements. Interventions carried out by incompetent and unauthorised persons can cause serious damage to the unit or physical and personal harm, not covered by the Manufacturer's warranty.
- Before installing the cooker, check the integrity and function of each part. Should anomalies be noted, do not proceed with installation and contact the Dealer.



Electrical safety

The electrical system to which the device is to be connected must be in accordance with local standards and supplied with earthed connection in compliance with safety regulations in the country of use. It must also comply with European standards regarding radio

antistatic properties.

The connection data (voltage and frequency) shown on the data plate of the cooker must match with those of the electric network.

Compare these data before connection. In case of doubts, refer to an electrician.

Before installing the hood, check that the electrical mains power supply corresponds with what is reported on the identification plate located inside the hood.

The socket used to connect the installed equipment to the electrical power supply must be within reach: otherwise, install a mains switch to disconnect the hood when required.

Any changes to the electrical system must be carried out by a qualified electrician.

Do not try to solve the problem yourself in the event of equipment malfunction, but contact the Dealer or an authorised Servicing Department for repairs.

WARNING: If the surface is cracked, switch off the appliance to avoid the possibility of electric shock

 **When installing the device, disconnect the equipment by removing the plug or switching off the main switch.**

Exception for Australia and New Zealand: For stationary appliances permanently connected to the fixed wiring, compliance with this requirement is considered to be met if the instruction concerning disconnection incorporated in the fixed wiring is in accordance with AS/NZS 3000

FUMES DISCHARGE SAFETY

 **Do no connect the equipment to discharge pipes of fumes produced from combustion (for example boilers, fireplaces, etc.).**

Before installing the hood, ensure that all standards in force regarding discharge of air out of the room have been complied with.

USE WARNINGS

 Before powering the appliance for the first time, remove any protective films and adhesives.

- While using, saucepans and kitchenware can cause noise that can depend on:
 - a high power level.
 - different materials of the bottom of saucepans
- **WARNING:** Fire hazard: do not store objects on cooking surfaces
- **WARNING:** The cooking process must take place under control. A short cooking process must be constantly monitored
- **WARNING:** automatic cooking on the hob with grease or oil can be dangerous and can cause fires. Do not try to extinguish a fire with water, but turn off the appliance and then cover the flame with a lid or fire blanket.
- Do not keep inflammable objects in the drawers below the cooker. The

- cutlery tray shall be made up of fire-resistant material.
- Do not keep metal objects directly below the cooker.
- Do not heat empty saucepans or frying pans and always check that saucepans have a minimum quantity of liquids inside.
- Possibly use always covers to avoid heat dispersion.
- Cook with little water.
- After starting grilling or cooking dishes bring the power level to a lower one.
- Switch off the cooker after use.
- Continuously check the cooking in case of greases and oils used, as they can easily catch fire.
- Heat greases and oils at maximum for one minute and never use the Booster function.
- Avoid that sugar, synthetic materials of aluminium, films are in contact with the hot areas. During cooling, those substances can cause cracks or other alterations on the pyroceram surface: switch off the device and immediately remove from the cooking area that is still hot
- Pay attention not to burn yourself during and after using the device.
- Make sure that no fixed or mobile power cable of the device is in contact with the glass or a hot frying pan.
- Do not use the cooker to heat pots.
- Do not apply any type of cover on the cooktop.
- Electrical cables are not to be in contact with the cooker.
- It is recommended to protect hands from heat using pot holders. Only use dry gloves or pot holders.
- Only use cookware with smooth and magnetic bottom suitable for induction hobs.
- Always use a saucepan or frying pan on each cooking area, even with the BRIDGE function.
- Do not place hot saucepans on the sensor keys or the LEDs, as this could cause damage to the electronic components underneath.
- Keep controls and lamps always clean.
- When moving saucepans, make sure to lift them rather than slide them over the surface.
- Saucepans and cooker are to be perfectly cleaned before being in contact.
- Do not drop objects on the hob!

 **Only use saucepans with magnetic bottom. Other materials are not admitted.**

Use saucepans of appropriate size to the desired cooking area.

SAUCEPAN SELECTION

Saucepans suitable for induction hobs:

The bottoms can be completely ferrous, non-ferrous or a blend of both materials.

Only saucepans with a fully magnetic, sufficiently wide and perfectly flat bottom are suitable for use on induction hobs.

The bottom is magnetic if a magnet sticks to every point on the bottom of the saucepan.

The minimum diameter of the bottom of the pan may vary depending on the cooking zone (see information below); the minimum diameter means the part of the pan that rests on the hob.

In pans with an all-ferrous flat bottom, the heat spreads evenly and the flat bottom prevents damage to the surface of the hob.

Suitable saucepans (examples):

- Thick-bottomed enamelled steel saucepans
- Cast iron saucepans with enamelled bottom
- Multi-ply stainless steel saucepans
- Ferritic stainless steel saucepans

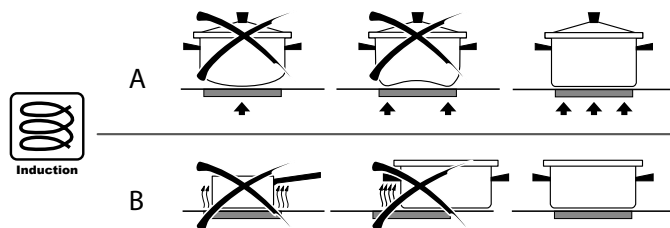
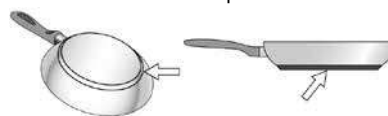

Saucepan bottom size- Brera 90:

Cooking area	Minimum size
Single	ø110mm
Bridge	230mm

Dimensione del fondo della pentola - Brera 75:

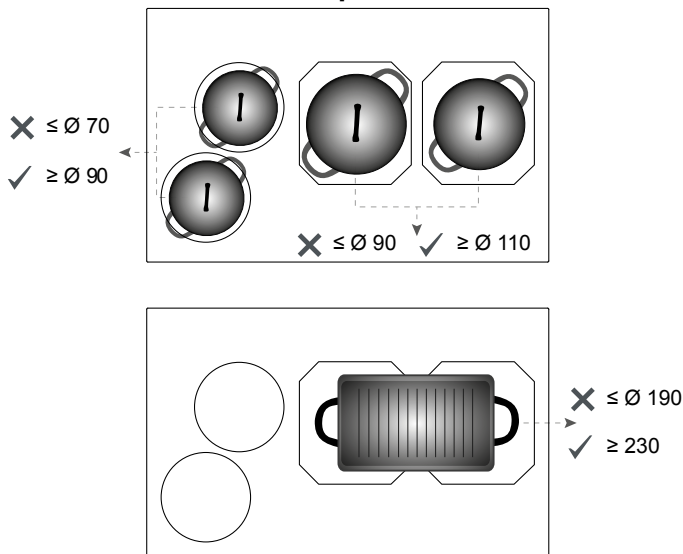

Saucepans not suitable for induction hobs:

Saucepans with non-magnetic or partially magnetic bottoms, with a size smaller than the indicated minimum and not perfectly flat are not suitable for use on induction hobs, even if bearing the symbol indicating them as suitable for induction.

In any case, these types of cookware have lower efficiency and lower cooking performance.

Bottoms with non-ferrous material (aluminium, copper, ...) cannot be used with induction hobs.

Bottoms with blended material might not heat evenly or therefore reach high temperatures. If bottoms mainly consist of non-ferrous material, the hob might not recognise the pan and the cooking zone does not switch on. Furthermore some of these materials tend to release material that bonds with the screen-printing of the glass, ruining it beyond repair.

The use of pans with uneven bottoms (e.g. with moulded pellets) can hinder the detection of the pan, does not guarantee homogeneity of heating and, again, can cause release of material as a result of thermal shock.

Unsuitable saucepans (examples):

- Copper saucepans
- Aluminium saucepans
- Ceramic saucepans
- Terracotta saucepans
- Stainless steel saucepans



Noise during cooking

Saucepans may generate noise during cooking: this is not a malfunction and does not affect the operation of the product.

The noise depends on the type of saucepan and the type of bottom;

If it is particularly unpleasant, it is recommended to replace the saucepan.

Humming, hissing, crackling sounds and vibrations are due to the transfer of energy to the bottom of the saucepan, and are generated by the various materials it is composed of. This noise is produced when cooking on a high power level and decreases as the set power level decreases.

Internal ventilation noise: the appliance is equipped with a ventilation module to adjust the internal temperature of the induction hob. Ventilation can remain on even after switching off the appliance.

SAFETY AND WARNING INDICATIONS

Warning for people wearing pacemakers:

Keep in mind that when the appliance is being used an electromagnetic field forms in the immediate proximity. There is therefore a remote possibility that the operation of the pacemaker might be affected.

If in doubt, contact the pacemaker manufacturer or your GP.

The electromagnetic field of the hob during operation can affect the operation of magnetisable objects. Credit cards, life-saving devices, pocket calculators etc. should not be in the proximity of a hob when in operation.

Metal objects stored in the drawer underneath the appliance may become hot in case of prolonged use. Do not store metal objects in a drawer immediately underneath the hob.

If the appliance is built-in over an oven or an electric cooker fitted with pyrolytic system, do not operate it while the pyrolytic procedure is under way, as the hob overheating device could trip (see relevant paragraph).

The appliance is equipped with cooling fans. If there is a drawer under a built-in appliance, a separation must be ensured between the drawer and the bottom of the appliance, for appropriate hob ventilation and to make sure the fans are not obstructed.

Never use two saucepans or pans on the same cooking zone, or a rectangular cooking zone, or a PowerFlex cooking area.



Before cleaning or carrying out maintenance operations, disconnect the equipment by removing the plug or switching off the main switch.

Do not use the hood with wet hands or bare feet.

Always check that all electrical parts (lights, extractor fan) are off when the equipment is not being used.



Do not rest objects on top of the motorised fins.

Always supervise the cooking process during the use of deep-fryers: Overheated oil can catch fire.

Never use the hood without the metal anti-grease filters: in this case, grease and dirt will deposit in the equipment and compromise its operation.

Accessible parts of the hood can be hot when used at the same time as the cooking appliances.

Do not carry out any cleaning operations when parts of the hood are still hot.

There can be a risk of fire if cleaning is not carried out according to the instructions and products indicated in this booklet.

Disconnect the main switch when the equipment is not used for long periods of time.



If other appliances that use gas or other fuels are being used at the same time (boiler, stove, fireplaces, etc.), make sure the room where the fumes are discharged is well-ventilated, in compliance with the local regulations.

PRODUCT DATA SHEET BRERA 90 - COOKTOP

Product information according to Regulation (EU) Nr. 66/2014

Calculation method: EN 60350-2:2018+ A1:2021

Manufacturer	Falmecc S.p.a.
Model identification	Brera 90
Type of hob	Glass ceramic cooktop
Number of cooking zones / cooking areas	4
Heating technology	Induction cooking zones and cooking surfaces
Useful surface area	4x(19,5x24,0 cm)

SIZE OF USABLE SURFACE

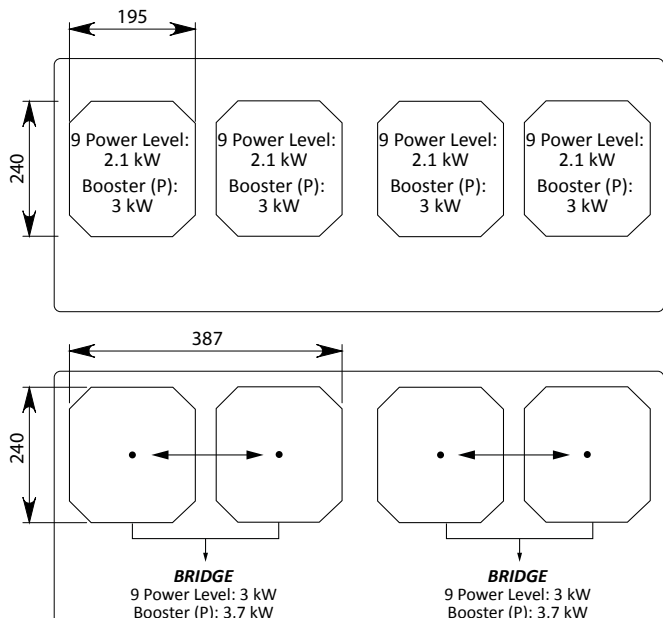

TOTAL POWER: 2,8 - 7,4 kW

ENERGY CONSUMPTION (Wh / Kg)

Energy consumption cooking zones:

1:	194,8 Wh/Kg		
2:	188,5 Wh/Kg		
3:	188,5 Wh/Kg		
4:	182,9 Wh/Kg		

Energy consumption of the hob: 188,7 Wh/Kg

PRODUCT DATA SHEET BRERA 75 - COOKTOP

Product information according to Regulation (EU) Nr. 66/2014

Calculation method: EN 60350-2:2018+ A1:2021

Manufacturer	Falmecc S.p.a.
Model identification	Brera 75
Type of hob	Glass ceramic cooktop
Number of cooking zones / cooking areas	4
Heating technology	Induction cooking zones and cooking surfaces
Useful surface area	2x(Ø 16,0 cm)+2x(20,5x21,0 cm)

SIZE OF USABLE SURFACE

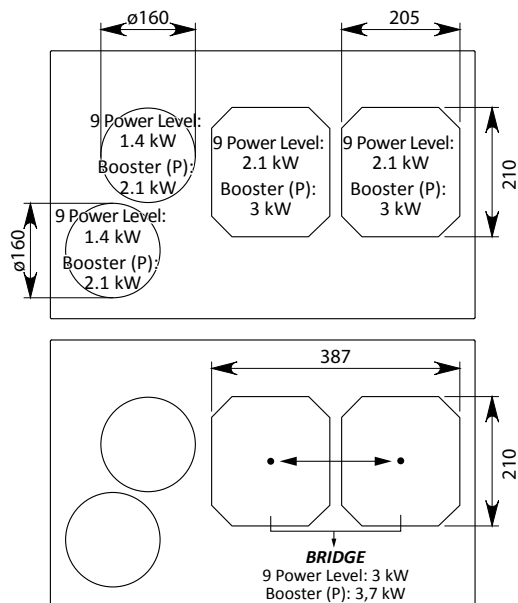

TOTAL POWER: 2,8 - 7,4 kW

ENERGY CONSUMPTION (Wh / Kg)

Energy consumption cooking zones:

1:	187,2 Wh/Kg
2:	182,3 Wh/Kg
3:	188,5 Wh/Kg
4:	188,5 Wh/Kg

Energy consumption of the hob: 186,6 Wh/Kg

INSTALLATION

only intended for qualified personnel



Before installing the hood, carefully read the chapter 'SAFETY INSTRUCTIONS AND WARNINGS'.

TECHNICAL FEATURES

The technical specifications are exhibited on the labels located inside the hood.

SAFETY INSTRUCTIONS FOR ASSEMBLY

Install the cooker after installing kitchen cabinets and basis. Make sure that worktops have been veneered with thermoresistant glue in order not to suffer deflections or detachments.

POSITIONING

Do not install the hood outdoors and do not expose it to outdoor environment (rain, wind, etc.).



It is forbidden to install the appliance on fridges or freezers, washing machines, dishwashers, or tumble driers.

COOKER

ELECTRICAL CONNECTION

(only intended for qualified personnel)



Disconnect the equipment from mains power network before carrying out any operation on the cooker.

Make sure that electric wires inside the cooker are not disconnected or cut:

in the event of damage, contact your nearest Servicing Department. Refer to qualified personnel for electrical connections.

Connection must be carried out in compliance with the provisions of law in force.

Before connecting the cooker to the mains power network, check that:

- the mains voltage corresponds with the voltage indicated on the data plate located inside the cooker;
- the electrical system is compliant and can withstand the load (see the technical specifications located inside the cooker);
- the power supply plug and cable do not come into contact with temperatures exceeding 70 °C;
- the power supply system is effectively and properly connected to earth in compliance with regulations in force.
- the socket used to connect the cooker is within reach.

In case of:

- devices fitted with cables without a plug: the type of plug to use is a "standardised" one. The wires must be connected as follows: yellow-green for earthing, blue for neutral and brown for the phase. The plug must be connected to an adequate safety socket.
- fixed equipment not provided with a power supply cable and plug, or any other device that ensures disconnection from the electrical mains, with an opening gap of the contacts that enables total disconnection in overvoltage category III conditions.
Said disconnection devices must be provided in the mains power supply in compliance with installation regulations.

The yellow/green earth cable must not be cut off by the switch.

The Manufacturer declines all responsibility for failure to comply with the safety regulations.

Connection of the cooker

network	Connection	Cable section	Power cable
220V - 240V~ 50/60Hz	1P+N / 2P	3 x 4 mm ²	H 05 VV - F H 05 RR - F
380V - 415V~ 50/60Hz	2P+N	4 x 1.5 mm ²	H 05 VV - F H 05 RR - F
380V - 415V~ 50/60Hz	3P+N	5 x 1.5 mm ²	H 05 VV - F H 05 RR - F

COOKER HOOD

FUMES DISCHARGE

EXTERNAL EXHAUST HOOD (SUCTION)



In this version the fumes and vapours are discharged outside through the exhaust pipe. To this end, the hood outlet fitting must be connected via a pipe, to an external output.

The outlet pipe must have:

- a diameter not less than that of the hood fitting.
- a slight slope downwards (drop) in the horizontal sections to prevent condensation from flowing back into the motor.
- the minimum required number of bends.
- the minimum required length to avoid vibrations and reduce the suction performance of the hood.
- You are required to insulate the pipes if it passes through cold environments.

Deviation for Germany:

when the kitchen hood is used at the same time as appliances that are powered by energy other than electricity, the negative pressure in the room must not exceed 4 Pa (4 x 10⁻⁵ bar).

HOOD WITH INTERNAL RECIRCULATION (FILTERING)



In this model, the air passes through the **Carbon-Zeo** (optional) filters to be purified and recycled in the environment.

Ensure that the **Carbon-Zeo** filters are assembled into the hood, if not, install them as indicated in the assembly instructions.

ASSEMBLY INSTRUCTIONS

only intended for qualified personnel



The hood can be installed in various configurations.

The generic assembly steps apply to all installations; for each case, follow the specific steps provided for the required installation.

OPERATION

WHEN TO TURN ON THE HOOD?

Switch on the hood at least one minute before starting to cook to direct fumes and vapours towards the suction surface.

After cooking, leave the hood operating until complete extraction of all vapours and odours. By means of the Timer function, it is possible to set auto switch-off function which will allow the hood to turn off automatically after 15 minutes of operation.

WHICH SPEED IS TO BE SELECTED?

speed (1-3): maintains the circulation of clean air with low electricity consumption.

speed (4-5): normal conditions of use.

speed (6-7): presence of strong odours and vapours.

speed (8-P): rapid disposal of odours and vapours.

With a view to reducing environmental impact, it is suggested to always set the minimum speed suitable for the required suction level.

WHEN SHOULD THE FILTERS BE WASHED OR REPLACED?

The metal filters must be cleaned every 30 hours of operation.

For further details see the "MAINTENANCE" chap.

HOOD TOUCH PUSHBUTTON PANEL

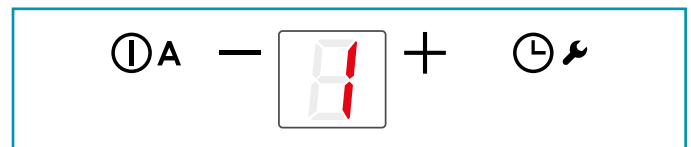

ⓘ A	ON/OFF Short pulse: Hood switch ON/OFF Long pulse: Hood operation automatic cycle activation (A) according to plate power.
+	Speed increase from 1 to...9 (up to "P"). Speed "P": active only for a few minutes, then speed 9 .
-	Speed decrease from P to 1.
🕒	With hood active (short pulse): TIMER (flashing red LED) Automatic switch-off after 15 min. The function is disabled (red LED OFF) if: - The motor is switched off (button ⓘ A). - Press the TIMER button 🕒 again.
	With the hood OFF (long pulse 4s): opening the fins for hood and filter maintenance

CARBON.ZEO FILTER ALARM

Maintenance after approximately 2000 hours of operation.

The display shows  alternating with the hood speed.



To reset the alarm: with the motor running, press the  key for 5 seconds.

The display shows  for 2 seconds.

To activate the alarm:

With the hood off, press the  and  keys for 5 seconds

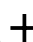

The display shows .

Press the  key to activate the alarm, the display shows  with the dot in the top left-hand corner flashing.
Wait 3 seconds, the configuration is saved

To deactivate the alarm:

With the hood off, press the  and  keys for 5 seconds,

The display shows .

Press the  key to deactivate the alarm, the display shows  with the dot in the top left-hand corner switched off.
Wait 3 seconds, the configuration is saved.



If the pushbutton panel is completely inactive, before contacting the Technical assistance service, disconnect power temporarily to the appliance (about 5"), possibly by acting on the main switch, to restore normal operation. If this measure has no effect, contact the Technical assistance service.

OPERATION AND USE OF THE COOKTOP

ONLY USE COOKWARE SUITABLE FOR INDUCTION HOBS.

When a cooking area is turned on, the bottom of the saucepan heats. The cooking area only heats thanks to the heat given by the saucepan. The cooktop automatically detects the size of the saucepan. The heating power is to be chosen based on what shall be cooked. With a view to reducing environmental impact, it is suggested to always set the minimum power level suitable for the required cooking. Please find below a short table:

SETTING AREAS

1 - 2	Melt Heat	Sauces, butter, chocolate, gelatine Precooked dishes
2 - 3	Whisk Defrost	Rice, pudding and cooked dishes Vegetables, fish, frozen food
3 - 4	Steam	Vegetables, fish, meat
4 - 5	Boil	Boiled potatoes, soups, pasta Fresh vegetables
6 - 7	Cook over a low heat	Meat, liver, eggs, sausages Goulash, rolate, tripe
7 - 8	Cook / Fry	Potatoes, donuts, cakes
9	Fry, bring to the boil	Steaks, omelettes, Boil
P	Fry, bring to the boil	Bring to the boil big quantities of water





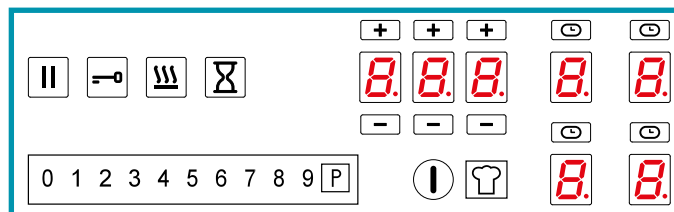

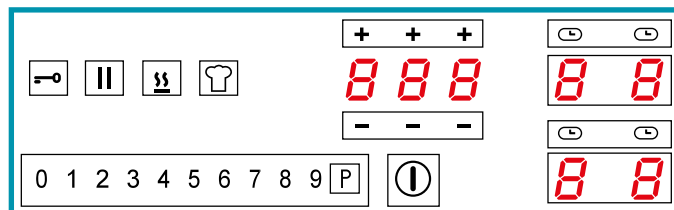

Remark: heating time of cooktops is shorter than the gas cookers.

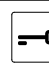

PUSH-BUTTON PANEL - BRERA 90

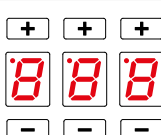
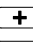
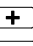
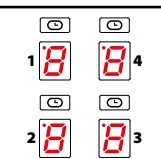

PUSH-BUTTON PANEL - BRERA 75



Control	description
	Cooker top ON/OFF. In case no other control is enabled, the cooker switches off automatically after a few seconds
	Pause key. It suspends cooking. See PAUSE function
	Control block key. Keyboard lock to prevent accidental controls
	KEEP WARM function key. Keeps cooking at a temperature of 44°C
	ONLY BRERA 90: Timer key. Activates the setting of a generic timer
	CHEF COOK key. Enables 4 cooking areas with different heating powers.
0 1 2 3 4 5 6 7 8 9	Power level selector switch Sets the power of the selected cooking area on a scale of 0 to 9
P	Booster key. Sets the power of the selected cooking area to the maximum available
	Timer area. Displays the set timer. The  and  keys increase or decrease the value shown on the corresponding display. The figures correspond from left to right: Hours, tens of minutes, minutes.
	Cooking area. Displays and selects the corresponding cooking area: 1 Left side 2 Central left 3 Central right 4 Right side
	Cooking area timer. Displays the activation of the timer linked to the corresponding cooking area

Display	description
	Cooking area in stand-by
	Selected cooking area
	Selected power level

	Power boost : maximum cooking power
	Residual heat indicator
	Keep warm function enabled
	Bridge function enabled
	Saucepan not present on the cooker top or not detected.
	Pause function enabled
	Child lock function enabled
	Automatic heating function enabled

POWER CHANGE PROCEDURE BRERA 90

CAUTION: reducing power results in a limitation of the power levels that can be set in individual areas. These limitations are automatically managed by the device.

Sequence	description
	With the top switched off Press the ON/OFF key
	Within 3 seconds, press the ON/OFF key again. The key starts flashing
	Press and hold the pause key
	The cooking area displays show: Press the four areas clockwise.
	Release the pause key
	The cooking area display shows the symbol alternating with the parameter number The Timer area displays the current setting of parameter The parameter for setting the power is U0.
	Press the Timer area to change the set power value. Press the power level selector: - left to decrease the value, - right to increase it
	Power Value Minimum: 1.4 2.8kW Maximum: 3.7 7.4kW Adjustment increment: 0.2kW

Sequence	description
	Press to exit parameter setting
	To save changes and exit the menu: - press the ON/OFF key for 2 seconds.
	To exit the menu without saving changes: - press the key

POWER CHANGE PROCEDURE BRERA 75

CAUTION: reducing power results in a limitation of the power levels that can be set in individual areas. These limitations are automatically managed by the device.

Sequence	description
	With the top switched off Press the ON/OFF key
	Within 3 seconds, press the ON/OFF key again. The key starts flashing
	Press and hold
	The cooking area displays show: Press the four areas clockwise.
	Release the key
	The cooking area display shows the symbol alternating with the parameter number The Timer area displays the current setting of parameter The parameter for setting the power is U0.
	Press the Timer area to change the set power value. Press the power level selector: - left to decrease the value, - right to increase it
	Power Value Minimum: 2.8 2.8kW Maximum: 7.4 7.4kW Adjustment increment: 0.1kW
	Press to exit parameter setting
	To save changes and exit the menu: - press the ON/OFF key for 2 seconds.
	To exit the menu without saving changes: - press the key

AUTOMATIC SWITCH-ON OF THE COOKING AREA

- Turn on the cooker top
- Place the saucepan, not empty, on the cooking area

- The key corresponding to the area is automatically switched on 
- The power level selector switch is activated by illuminating level 0

0 1 2 3 4 5 6 7 8 9

- Press the key of the cooking area to be set. The bottom right-hand dot lights up 
- Adjust the desired power level.

POWER LEVEL ADJUSTMENT:

- Slide your finger to the right in the power level selector switch and stop at the desired level.



- The display of the selected cooking area shows the set power level:





- Press the **P** key to activate the booster level.

The display of the selected cooking area shows . The booster level is maintained for a maximum of 5 minutes, after which the power level is raised to 9.

SWITCHING OFF THE COOKING AREA:

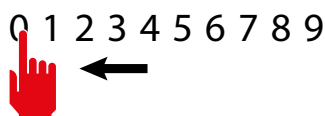

- Slide your finger to the left in the power level selector switch and stop at level 0.



- The display of the selected cooking area shows the power level 0: 

NOTE: all cooking areas can be switched off at the same time: press key  for 2 seconds..

On the display of the cooking areas that are still too hot, the symbol is

displayed . Do not touch the cooking areas as long as the lamp  is on.

BRIDGE FUNCTION:

- This function allows for the simultaneous operation of the cooking areas: 1-2 and/or 3-4; for the use of fish kettles or large rectangular saucepans.

ONLY BRERA 90:

NOTES: Automatic BRIDGE detection: the appliance automatically suggests the BRIDGE function if a sufficiently large saucepan is placed over cooking areas 1-2 or 3-4.

To make the function active, press the flashing button  within 10 seconds.





To activate the BRIDGE function manually:



- Press the keys of the two cooking areas to be paired simultaneously.

CAUTION: only the indicated pairs can be coupled: front and back right area (1-2) or front and back left area (3-4).

- An acoustic signal warns of the activation of the function, the displays show:

- Adjust the desired power level. 
- 
- 
- 

To disable the BRIDGE function:



- Press the buttons of the two paired cooking zones at the same time.

KEEP WARM FUNCTION



keeps food warm at a temperature of around 44°C

- Press the key of the cooking area to be set.

The bottom right-hand dot lights up 

- Press the Keep Warm  key. - The cooking area display indicates the activation of the function .

To deactivate the KEEP WARM function:

- Press the cooking area key with the Keep Warm function active 
- Press the Keep Warm  key.

CHEF COOK FUNCTION::

enables 4 cooking areas with four different powers, from left to right

- Press the Chef Cook key . The cooking area display indicates the activation of the area and the power level.

BRERA 90



BRERA 75



To deactivate the CHEF COOK function:

- Press the Chef Cook key .

PAUSE FUNCTION

suspends the operation of all cooking areas.

- Press the pause key 
- The cooking area displays indicate the activation of the pause function

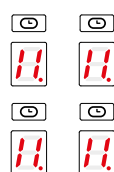

The Pause function can only be activated for 10 minutes, after which the device switches off.

To deactivate the PAUSE function:



- Press the pause key . The key starts flashing
- Press any key except the Pause key.
- The function is disabled and the cooking areas will resume operation prior to activation of the Pause function.

NOTE: Interruption and restoration of the power supply deactivates the PAUSE function.

CONTROL BLOCK FUNCTION:

disables all device keys to prevent accidental activation when cleaning the cooker top.

- Press the Control block key  for 1 second

All keys except the Control block  and ON/OFF  keys are disabled.

To deactivate the CONTROL BLOCK function:

- Press the Control block key  for 1 second

**CHILD LOCK FUNCTION:
deactivates operation of all keys**

- **IMPORTANT:** perform the entire procedure within 10 seconds

- Press a cooking area key for 3 seconds 

- Release the key and slide your finger to the right in the power level selector switch from 0 to 9

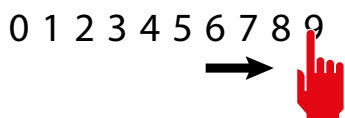

- The cooking area display indicates the activation of the function



To deactivate the CHILD LOCK function:

- **IMPORTANT:** perform the entire procedure within 10 seconds

- Press a cooking area key for 3 seconds 

- Release the key and slide your finger to the left in the power level selector switch from 9 to 0

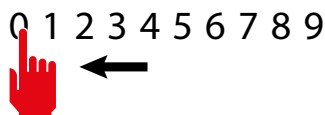

TIMER FUNCTION



allows you to set a time after which an acoustic alarm will sound.

- **Brera 90:** Press the Timer key 

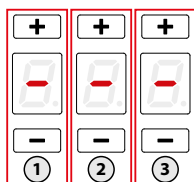
- **Brera 75:** Press Timer area

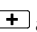

- The Timer area is activated:

- Press the  and  keys to set the timer.

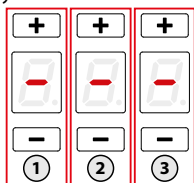

Area 1: hours

Area 2: tens of minutes

Area 3: minutes

Maximum setting time: 9 hours 59 minutes

- After 10 seconds the timer will start the countdown.

- At the end of the countdown, an acoustic signal will sound.

- Press any key to deactivate the acoustic signal.

COOKING AREA TIMER FUNCTION:

allows a cooking area to be switched off after a set time

- Press the key of the cooking area to be set. The bottom right-hand dot



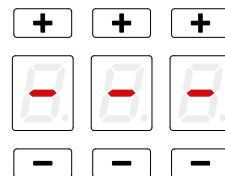

lights up

- Press on the Timer area.

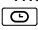

- The timer area is activated:

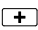
 above the cooking area flashes.

- Press the  and  keys to set the timer.

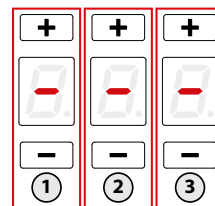

Area 1: hours

Area 2: tens of minutes

Area 3: minutes

Maximum setting time: 9 hours 59 minutes

- After 5 seconds the timer will start the countdown.

- At the end of the countdown, the relevant cooking area will be switched off and an acoustic signal will sound.

- Press any key to deactivate the acoustic signal.

AUTOMATIC HEATING FUNCTION:

sets the maximum power for a preset time and returns to the previous power level.

- Press the key of the cooking area to be set. The bottom right-hand dot



lights up

- Slide your finger to the right in the power level selector switch and stop at the desired level. The function can only be activated for levels 1 to 8.



- Press and hold the selected level for 3 seconds

3 sec

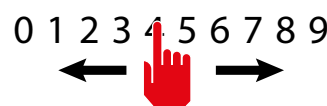

This will also be the level to which the cooking zone will be returned at the end of the preset time, during which the cooking zone will run at maximum power.



- The cooking area display indicates the activation of the function

Function duration table:

Power level	Automatic heating function time (seconds)
1	48
2	144
3	230
4	312
5	408
6	120
7	168
8	210
9	Function not available
P	Function not available

- When the time elapses, the function ends and the cooking area is reset to the previously set power level.

To deactivate the AUTOMATIC HEATING function:

1 - Wait for the end of the function time

or

2 - Press the cooking area key for 3 seconds



- the function ends and the cooking area is reset to the previously set power level.

or

3- If a lower power level is set than before the automatic heating function, the function is deactivated.

RECALL FUNCTION:

enables the recovery of cooking settings prior to an accidental cooker top switch-off.

- Perform the following steps within 6 seconds of an accidental switch-off

- Turn on the cooker top

- The pause key flashes

- Press the pause key

The RECALL function resets the operation of the cooking areas, timer functions and quick heating. Other functions will not be restored.

SAFETY DEVICES ON THE COOKER

Safety shutdown

If a cooking area exceeds the maximum time for operation at the same power, it is automatically switched off and the indication of the residual heat is shown.

To reset the cooking area, touch the necessary keys.

Power level	1	2	3	4	5	6	7	8	9	P
Maximum duration of operation in hours	6	6	5	5	4	1,5	1,5	1,5	1,5	5 min

The cooker switches off automatically if one or more controls stay covered for more than 10 seconds.

To restore the proper operation:

- remove all objects from the control panel.
- clean the control panel.
- restart the cooker and the concerned area.

Overheating device

Before items of the cooker can overheat, the control reduces the used power by following this procedure for protection measures:

- Deactivation of booster and power booster if turned on.
- Reduction of the power level set.
- Shutdown of the cooking area concerned.

On the display of the cooking area the message "E2" is displayed.

It is possible to restore the cooking area when the default message is off.

CLEANING AND MAINTENANCE

Regular maintenance guarantees proper operation and performance over time.



ATTENTION!

For cleaning, never use a steam equipment.

Before cleaning the cooker, make sure that it is at room temperature. Always clean the hob after each use with a specific glass-ceramic cleaner, taking care to remove food residues and any encrustations immediately. A solution of water, preferably distilled, and white vinegar can be useful to remove limescale stains and soften encrustations before removing them with the appropriate scraper.

Never use alcohol on the hob surface.

Do not use products containing:

- corrosive agents (soda, acids, ammoniac).
- abrasive agents (dusts or paste).

Do not use pointed or abrasive objects.

After cleaning, dry the appliance with a soft cloth.



Never drag the pans across the hob, but lift them, so as to avoid scratches.



Do not wash the flaps in a dishwasher.

USEFUL CARE TIPS

Clean your glassceramic cooktop regularly, preferably every time you use it. Avoid using abrasive sponges or scouring agents.

Harsh chemical cleaners like oven sprays or stain removers are also unsuitable, as are bathroom or household cleaners.

Accidents happen ...

Do not allow the hot hob to come into contact with plastic, tin foil, sugar or sugary food have fallen on the hot glass-ceramic cooktop. Please scrape it off the hot surface as quickly as possible. If these substances melt, they can damage the glass-ceramic cooktop.

Sparkling results in only three steps:

To thoroughly clean your glass-ceramic cooktop, first remove dirt and food with a suitable metal scraper.

Once the glass-ceramic cooktop has cooled, put a few drops of a suitable cleaner on it and rub it on with a paper towel or a clean cloth.

Then wipe the glass-ceramic cooktop with a damp cloth and dry it with a clean cloth.

How do I identify a suitable glass-ceramic scraper?

- Scraper made of metal (won't melt or catch fire)
- Scraper easy to lock / to unlock
- Blade is fixed precisely, it does not shift
- Blade is unbroken, clean and stainless
- Scraper certified by testing institute, if procurable (e.g. TÜV-GS seal)
- User manual and safety instructions available

CLEANING OF INTERNAL SURFACES



Do not clean electrical parts, or parts related to the motor inside the hood, with liquids or solvents.

For the internal metal parts, see the previous paragraph.

METAL ANTI-GREASE FILTERS

It is advised to frequently wash the metal filters (F) (at least once a month) leaving them to soak in boiling water and cleaning solution for 1 hour, taking care not to bend them.

Do not use corrosive, acid or alkaline detergents.

Rinse them well and wait for them to be completely dry before reassembling them.

Washing in a dishwasher is permitted, however, it may cause the filter material to darken: to reduce this, use washes at low temperatures (60°C max.) without detergent.

To extract and insert the metal anti-grease filters see the assembly instructions.

CARBON AND ZEOLITE FILTERS (OPTIONAL)

For the service life and regeneration of filters, refer to the specific instructions supplied with their packaging.

Wait until the filter cools before reassembling it.

GREASE DRIP TRAY

It is advisable to clean the tray every 1 month.

Do not use corrosive, acid or alkaline detergents.

For more thorough cleaning, remove the oil collection tray (see figure) and wash it with water and washing up liquid. Rinse it well and wait for it to be completely dry before reassembling it.



Do not wash the grease drip tray in a dishwasher.

WHAT TO DO IN CASE OF COOKERS PROBLEMS

The cooker or cooking areas do not turn on:

- The cooker is not connected to the electric network.
- The protection fuse is released.
- Check if the block is not active.
- Keys are covered with water or grease.
- An object is placed on the keys.

The symbol is displayed .

- There is no saucepan on the cooking area.
- The container used is not compatible with cooktops.
- The diameter of the saucepan bottom is too small compared to the cooking area.

The symbol [E] is displayed:

- Disconnect and connect the cooker.
- Contact the after-sales centre.

One of the area or the entire cooker turns off:



- The safety overheating system is active;
- The cooker or one cooking area remains on for too long;
- one or more keys are covered;
- one of the saucepans is empty and the bottom overheated.

The fan keeps on working after the cooker shutdown:

- This is not a malfunction: the fan keeps on protecting the electronic power unit of the device.
- The fan stops automatically.

COOKERS ERROR CODES

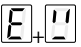
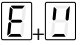
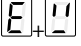
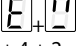
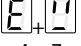
In case of error, the device displays error codes for support purposes. The display of the cooking area shows the error code alternating 'E' with other symbols and numbers.

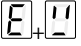
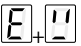
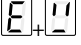
Error code	Description	Possible causes	Solution
 + 0 + 3	Continuous activation of a key	- Metal objects above the keyboard - water over the keyboard	- Move the metal objects - Dry the water
 + 2 + 1	Internal temperature above 85°C	- covered or insufficient ventilation areas	- Allow internal heat dissipation
 + 3 + 1	Incorrect configuration	- configuration error	- Contact Technical Support/assistenza tecnica
 + 4 + 2	Internal supply voltages too high or low	Overcharging due to atmospheric discharge, electrical system failure or incorrect power connection	- Contact Technical Support
 + 4 + 7	No communication between keyboard and inductor modules	- Communication cable damaged or disconnected - Damaged inductor module	- Contact Technical Support
 + 2 + 0  + 2 + 2  + 3 + 5  + 3 + 6	Control keyboard internal error		- Contact Technical Support

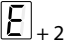
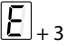
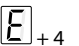
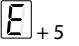
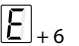
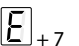
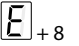
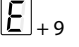
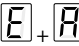
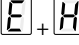
 + 2	Temperature limits were exceeded in the cooking area	- Empty saucepan - unsuitable saucepan type - saucepan or glass too hot	- fill the saucepan - use a suitable saucepan - remove the saucepan and allow the area to cool down
 + 3	Unsuitable saucepan	- The saucepan has little ferritic material - The saucepan caused an error in the inductor module - Inductor failure	- Use a suitable saucepan - Remove the saucepan, wait 8 seconds and try again - Contact Technical Support
 + 4	Incorrect configuration	- inductor configuration error	- Contact Technical Support
 + 5	No communication between keyboard and generator	- Faulty or disconnected LIN cable - Incorrect electrical connection - Internal fault - Configuration error	- Contact Technical Support - Check terminal board electrical connection - Contact Technical Support - Contact Technical Support
 + 6	Incorrect power supply	- Out-of-range supply voltage - Incorrect supply voltage frequency - Inductor failure	- Check that the supply voltage is correct: voltage and frequency. - Contact Technical Support
 + 7	Internal inductor failure		- Contact Technical Support
 + 8	Cooling fan not working	- Dirty fan - Fan Failure	- Clean the air vents - Contact Technical Support
 + 9	Faulty inductor temperature probe	- Faulty inductor temperature probe	- Contact Technical Support
 + A	Internal inductor failure		- Contact Technical Support
 + H	Inductor temperature probe has a fixed value	- glass too hot - faulty probe	- Cool the glass - Contact Technical Support

Note:

Not each failure can be detected automatically by the system, e.g. in case of defect of the User interface power supply.

DISPOSAL AFTER END OF USEFUL LIFE



The crossed-out wheeled bin symbol on the appliance means that **the product is WEEE**, i.e. "Waste electrical and electronic equipment", accordingly **it must not be disposed of with unsorted waste** (i.e. with "mixed household waste"), but it must be disposed of separately so that it can undergo specific operations for its re-use, or a specific treatment, to remove and safely dispose of any substances that may be harmful to the environment and remove the raw materials that can be recycled. Proper disposal of these products contributes to saving valuable resources and avoid potential negative effects on personal health and the environment, which may be caused by inappropriate disposal of waste.

You are kindly asked to contact your local authorities for further information regarding the designated waste collection points nearest to you. Penalties for improper disposal of such waste can be applied in compliance with national regulations.

INFORMATION ON DISPOSAL IN EUROPEAN UNION COUNTRIES

The EU WEEE Directive was implemented differently in each country, accordingly, if you wish to dispose of this appliance we suggest contacting your local authorities or dealer to find out what the correct method of disposal is.

INFORMATION ON DISPOSAL IN NON-EUROPEAN UNION COUNTRIES

The crossed-out trash or refuse bin symbol is only valid in the European Union: if you wish to dispose of this appliance in other countries, we suggest contacting your local authorities or dealer to find out what the correct method of disposal is.



WARNING!

The Manufacturer reserves the right to make changes to the equipment at any time and without prior notice. Printing, translation and reproduction, even partial, of this manual are bound by the Manufacturer's authorisation.

Technical information, graphic representations and specifications in this manual are for information purposes and cannot be divulged.

This manual is written in Italian. The Manufacturer is not responsible for any transcription or translation errors.